

Cast Iron Pipes

DESCALING

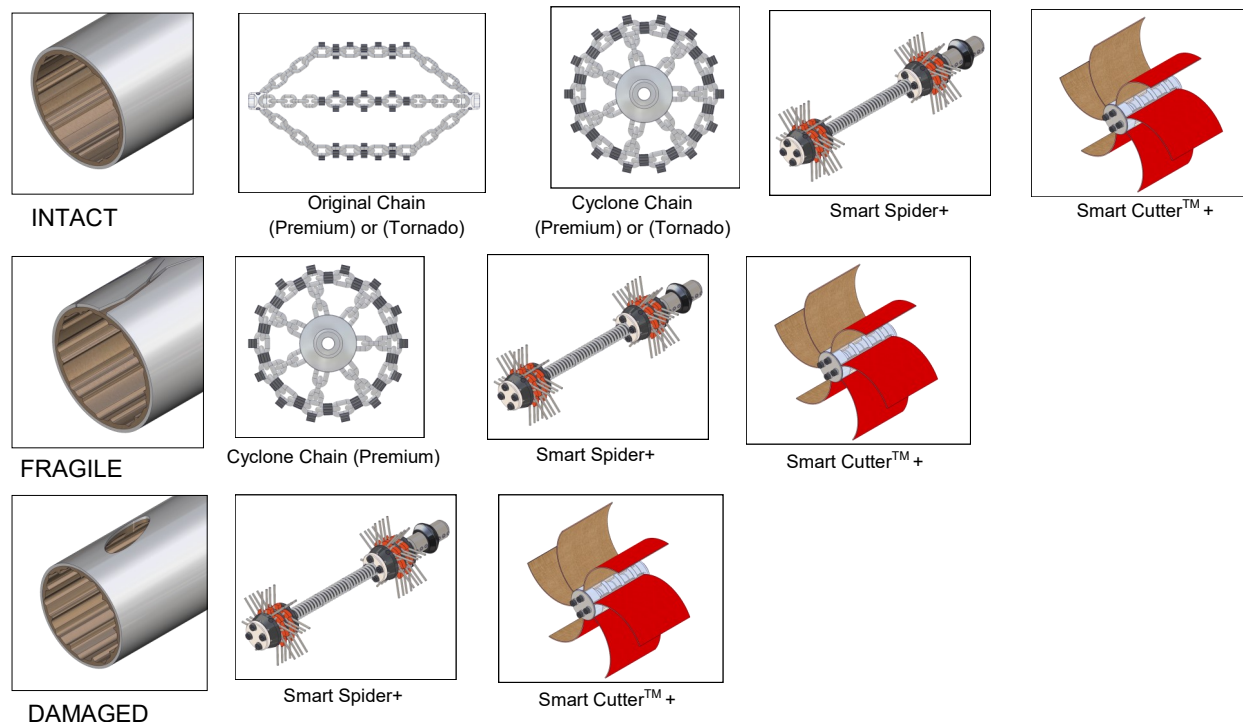

SPECIAL

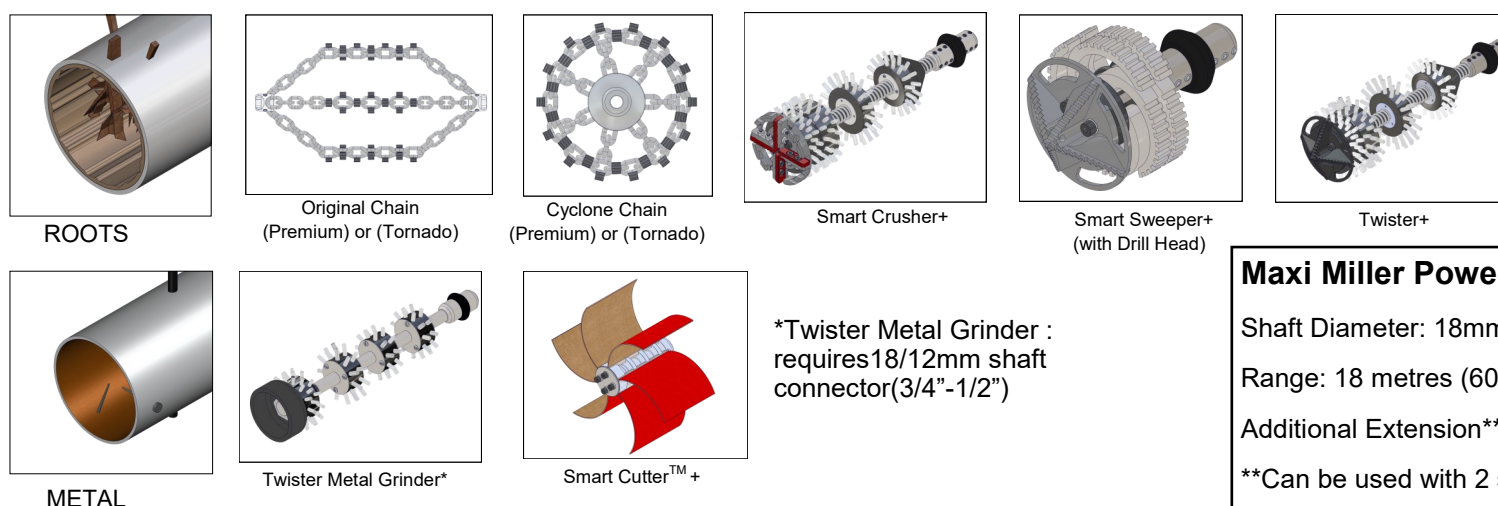

Maxi Miller Power+

Shaft Diameter: 18mm (3/4")

Range: 18 metres (60ft)

Additional Extension**: 11 metres (36ft)

**Can be used with 2 shaft extensions sold separately.

Recommended Diameter Range:

DN100 (4") Straight Pipes Only

DN150 (6") - DN300 (12")

Power Supply:

3-Phase, 400-480V, EU/UK: 16A USA:30A

COLLAPSED LINER

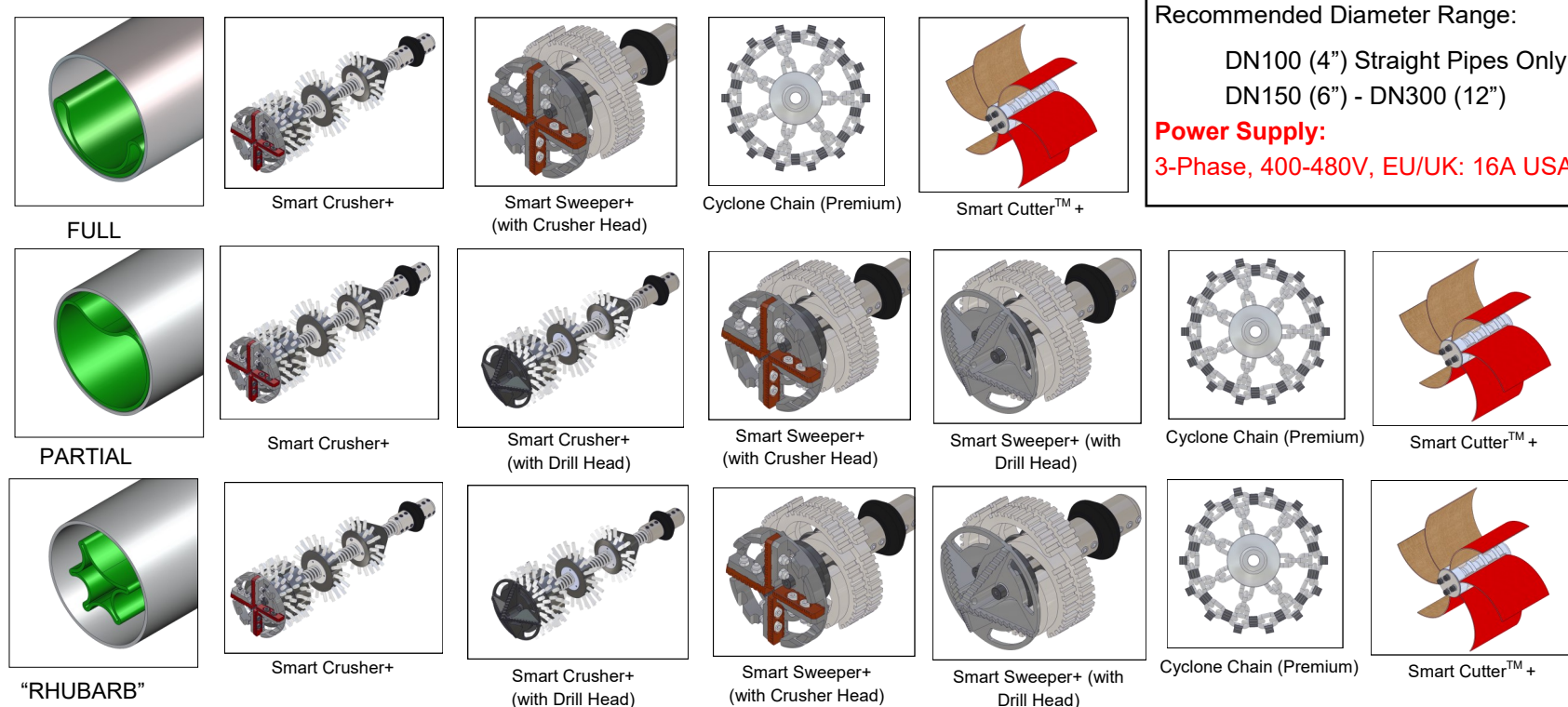

Maxi Miller Power+

Available Tools

Size Range

Original Chain (Tornado)	DN100 (4") - DN300 (12")
Original Chain (Premium)	DN100 (4") - DN300 (12")
Cyclone Chain (Tornado)	DN150 (6") - DN300 (12")
Cyclone Chain (Premium)	DN100 (4") - DN300 (12")
Smart Spider+	DN150 (6") - DN225 (9")
Smart Crusher+	DN70 (3")** - DN225 (9")
Smart Sweeper+	DN150 (6") - DN225 (9")
Smart Cutter™+	DN100 (4") - DN300 (12")
Twister+	DN150 (6") - DN300 (12")
Twister Concrete Remover+	DN150 (6") - DN225 (9")
Twister Metal Grinder*	DN100 (4")

** 70mm (3") is suitable for DN100 (4") pipes and above

CONCRETE

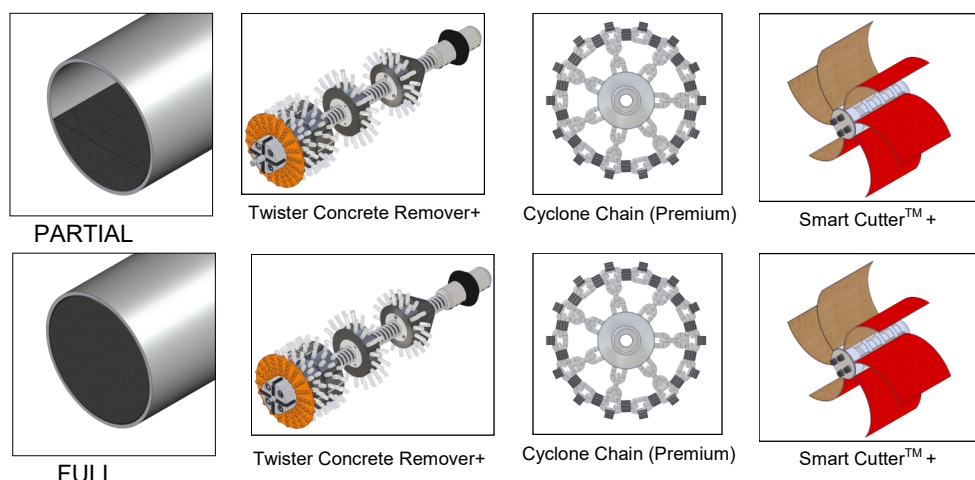

Clay Pipes

DESCALING

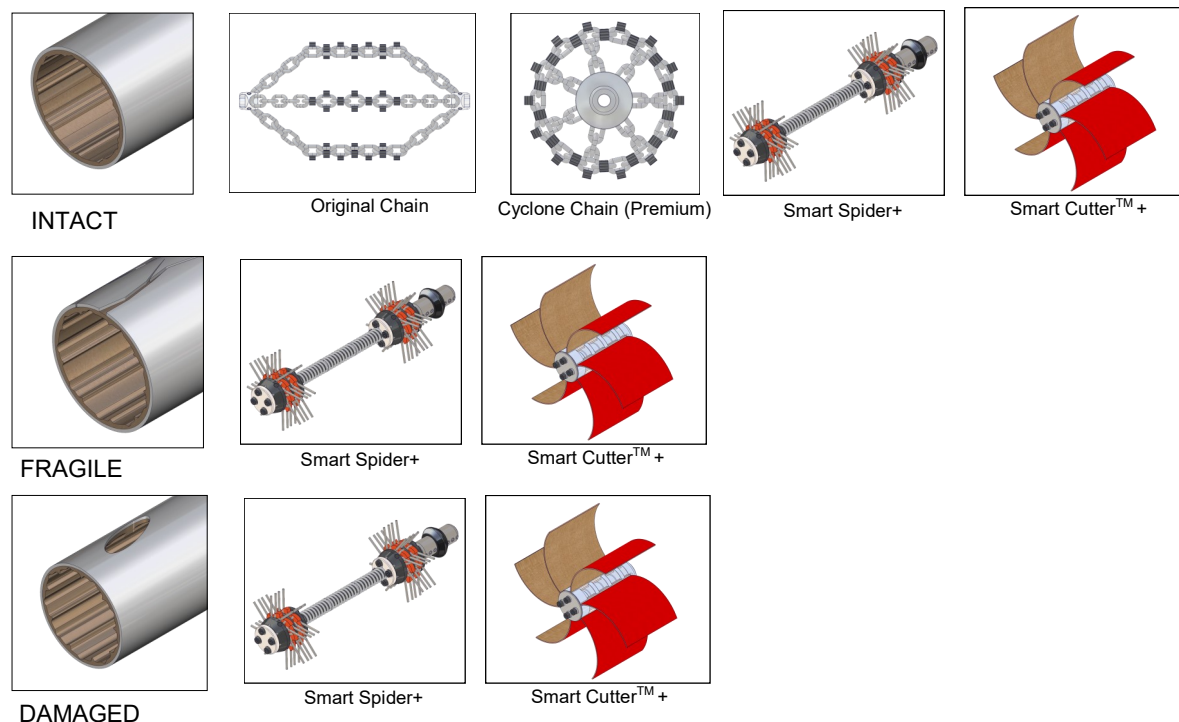

SPECIAL

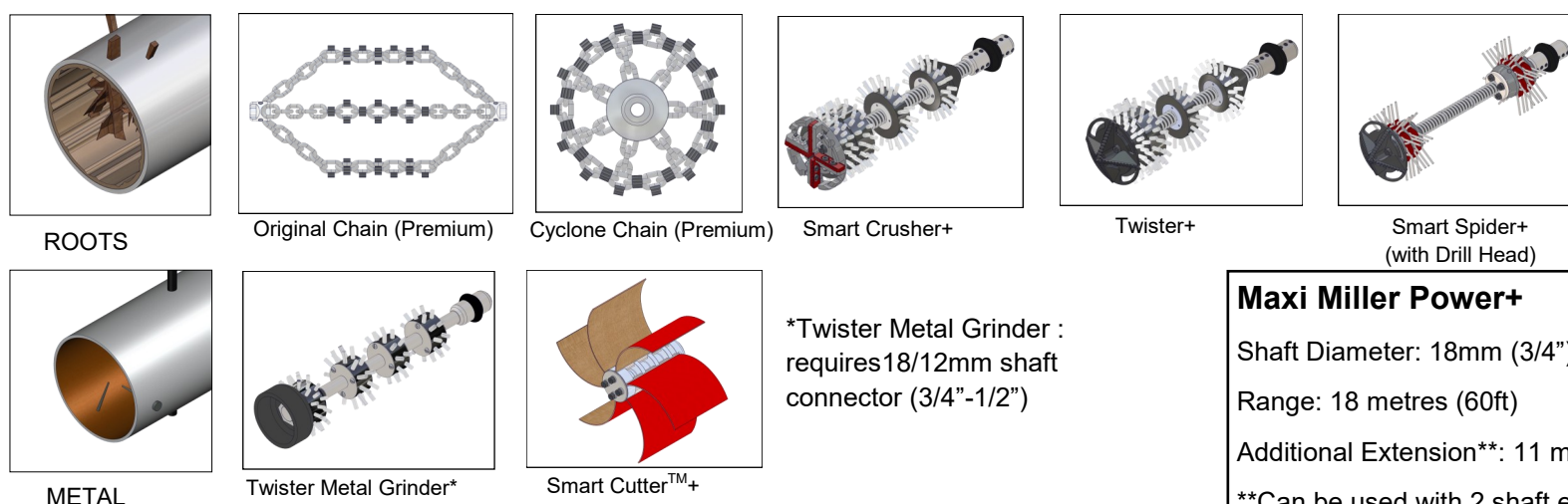

*Twister Metal Grinder : requires 18/12mm shaft connector (3/4"-1/2")

Maxi Miller Power+

Shaft Diameter: 18mm (3/4")

Range: 18 metres (60ft)

Additional Extension**: 11 metres (36ft)

**Can be used with 2 shaft extensions sold separately.

Recommended Diameter Range:

DN100 (4") Straight Pipes Only

DN150 (6") - DN300 (12")

Power Supply:

3-Phase, 400-480V, EU/UK: 16A USA:30A

COLLAPSED LINER

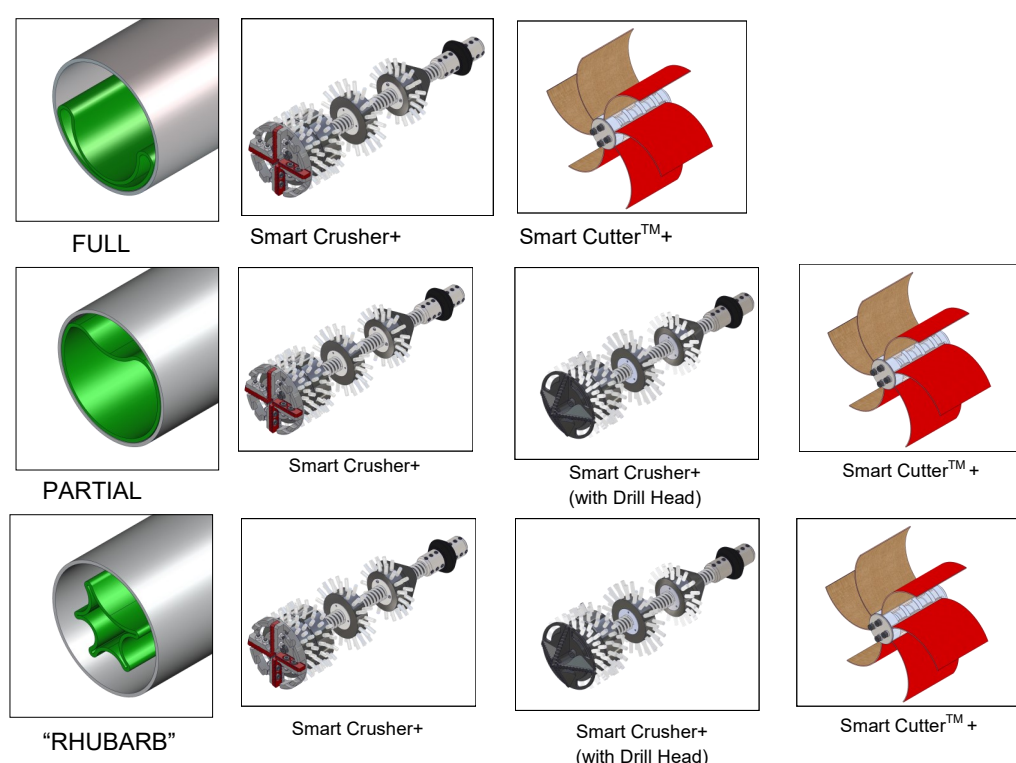

Maxi Miller Power+

Available Tools

Size Range

Original Chain (Tornado)	DN100 (4") - DN300 (12")
Original Chain (Premium)	DN100 (4") - DN300 (12")
Cyclone Chain (Tornado)	DN150 (6") - DN300 (12")
Cyclone Chain (Premium)	DN100 (4") - DN300 (12")
Smart Spider+	DN150 (6") - DN225 (9")
Smart Crusher+	DN70 (3")** - DN225 (9")
Smart Cutter™+	DN100 (4") - DN300 (12")
Twister+	DN150 (6") - DN300 (12")
Twister Concrete Remover+	DN150 (6") - DN225 (9")
Twister Metal Grinder*	DN100 (4")

**70 mm (3") is suitable for DN100 (4") pipes and above

CONCRETE

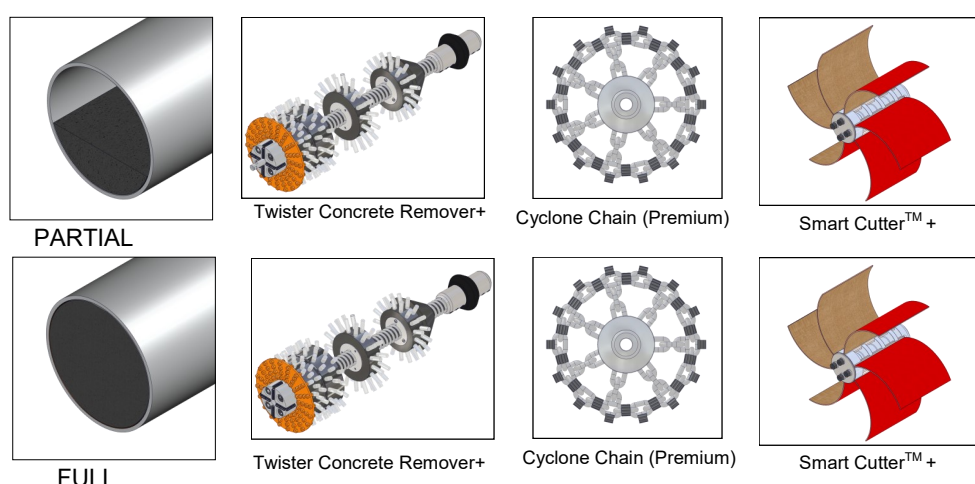

DESCALING

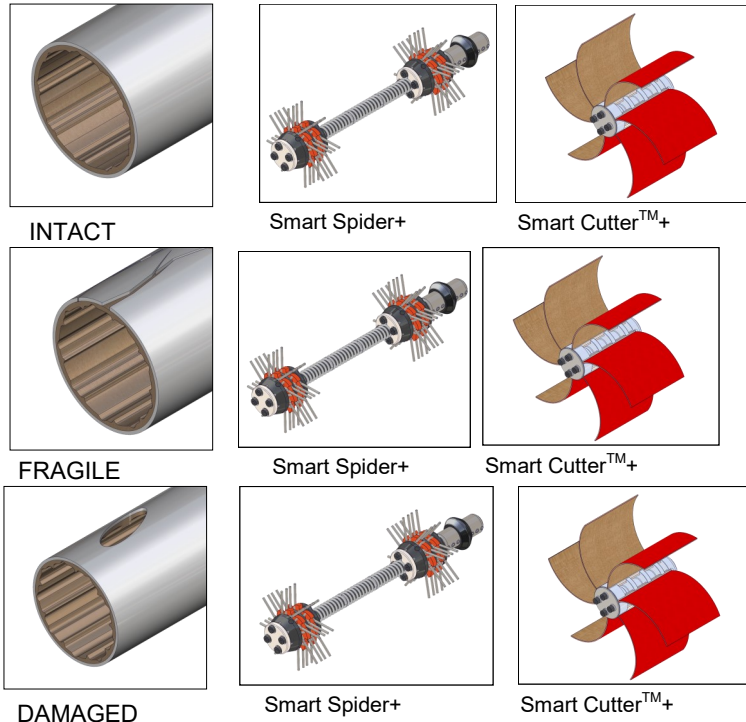

SPECIAL

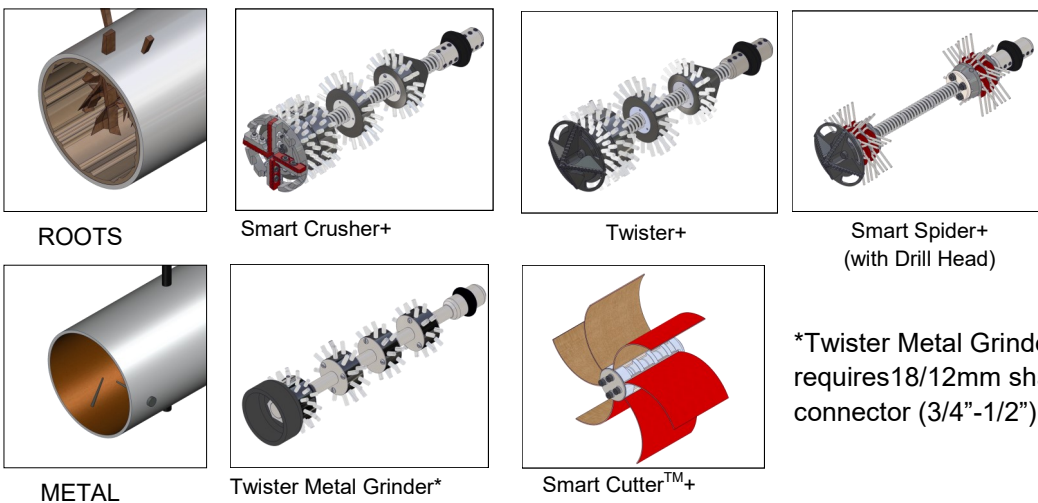

*Twister Metal Grinder : requires 18/12mm shaft connector (3/4"-1/2")

COLLAPSED LINER

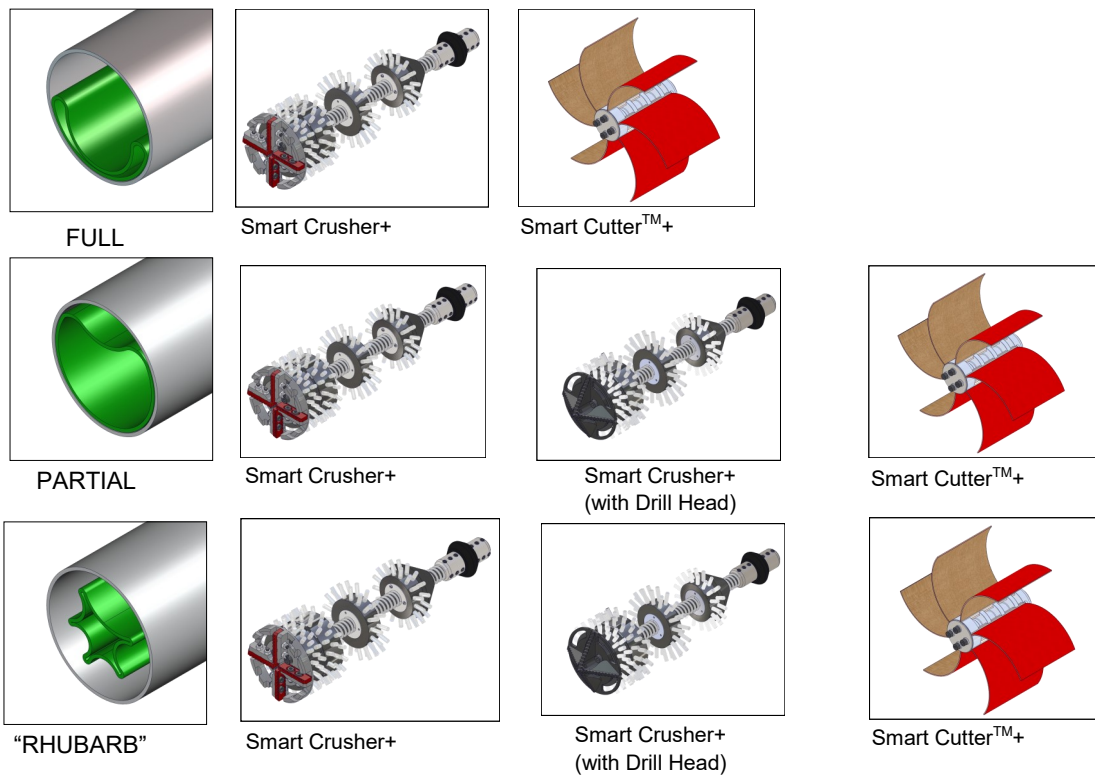

Maxi Miller Power+

Shaft Diameter: 18mm (3/4")

Range: 18 metres (60ft)

Additional Extension**: 11 metres (36ft)

**Can be used with 2 shaft extensions sold separately.

Recommended Diameter Range:

DN100 (4") Straight Pipes Only

DN150 (6") - DN300 (12")

Power Supply:

3-Phase, 400-480V, EU/UK: 16A USA:30A

CONCRETE

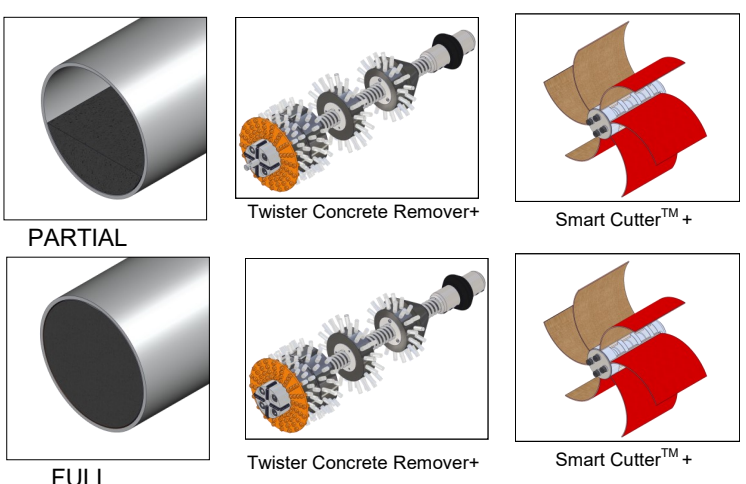

Maxi Miller Power+

Available Tools

Size Range

Smart Spider+	DN150 (6") - DN225 (9")
Smart Crusher+	DN70 (3")** - DN225 (9")
Smart Cutter™+	DN100 (4") - DN300 (12")
Twister+	DN150 (6") - DN300 (12")
Twister Concrete Remover+	DN150 (6") - DN225 (9")
Twister Metal Grinder*	DN100 (4")

*70mm (3") is suitable for DN100 (4") pipes and above

Cast Iron Pipes

STANDARD

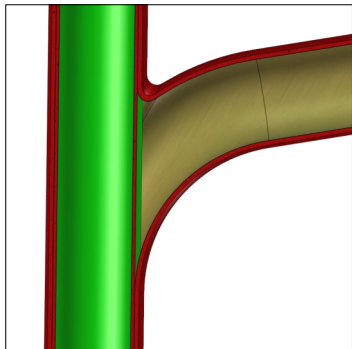

UNLINED

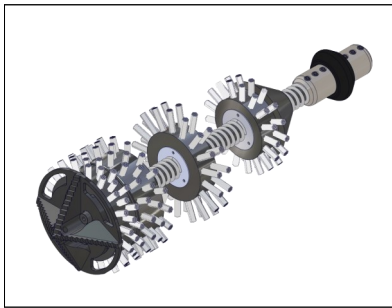

Twister+

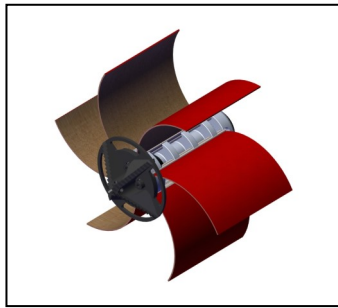

Smart Cutter™+

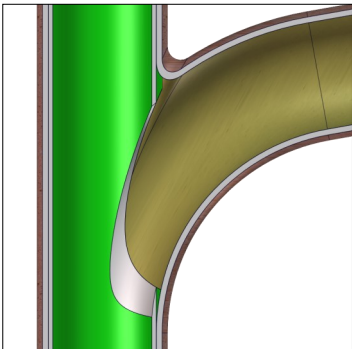

OPENED

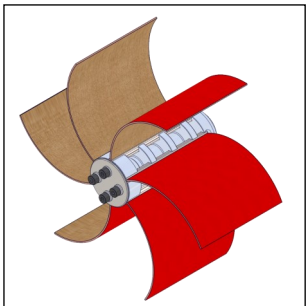

Smart Cutter™+

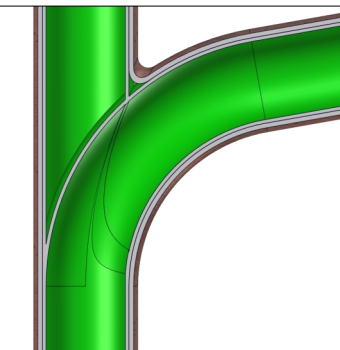

LINED

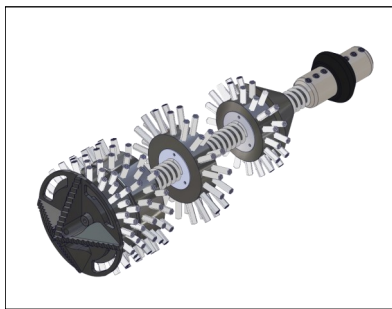

Twister+

SPECIAL

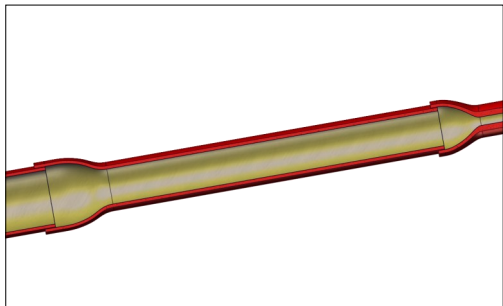

SIZE CHANGE

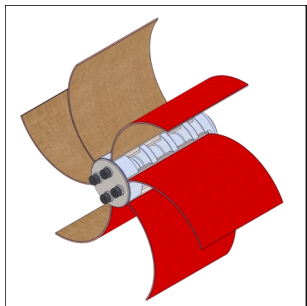

Smart Cutter™+

Maxi Miller Power+

Shaft Diameter: 18mm (3/4")

Range: 18 metres (60ft)

Additional Extension**: 11 metres (36ft)

**Can be used with 2 shaft extensions sold separately.

Recommended Diameter Range:

DN100 (4") Straight Pipes Only

DN150 (6") - DN300 (12")

Power Supply:

3-Phase, 400-480V, EU/UK: 16A USA:30A

Maxi Miller Power+

Available Tools

Size Range

Twister+

DN150 (6") - DN300 (12")

Smart Cutter™+

DN100 (4") - DN300 (12")

Clay Pipes

STANDARD

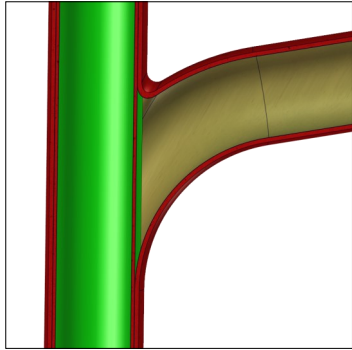

UNLINED

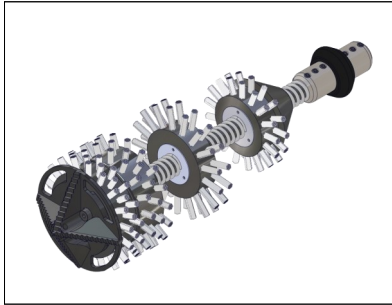

Twister+

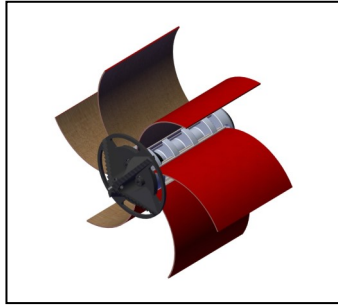

Smart Cutter™+

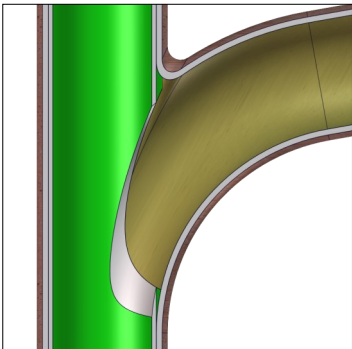

OPENED

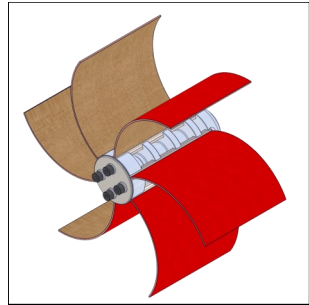

Smart Cutter™+

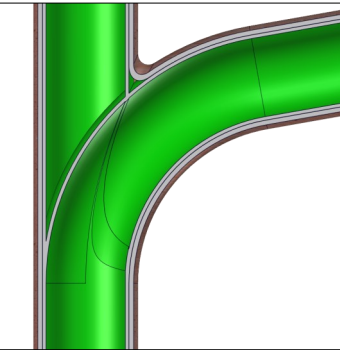

LINED

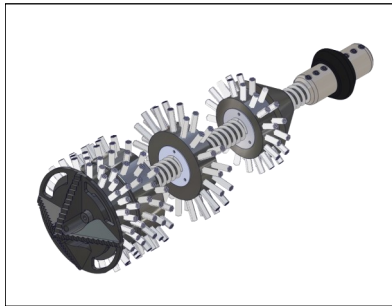

Twister+

SPECIAL

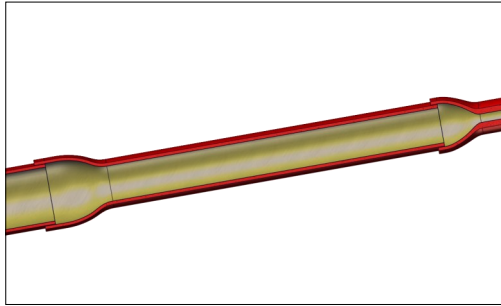

SIZE CHANGE

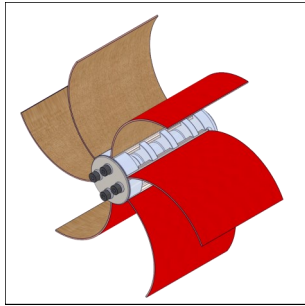

Smart Cutter™+

Maxi Miller Power+

Shaft Diameter: 18mm (3/4")

Range: 18 metres (60ft)

Additional Extension**: 11 metres (36ft)

**Can be used with 2 shaft extensions sold separately.

Recommended Diameter Range:

DN100 (4") Straight Pipes Only

DN150 (6") - DN300 (12")

Power Supply:

3-Phase, 400-480V, EU/UK: 16A USA:30A

Maxi Miller Power+

Available Tools

Size Range

Twister+

DN150 (6") - DN300 (12")

Smart Cutter™+

DN100 (4") - DN300 (12")

STANDARD

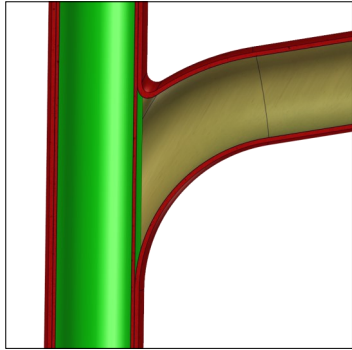

UNLINED

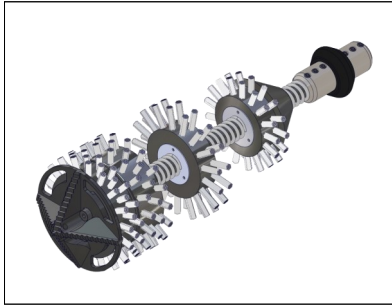

Twister+

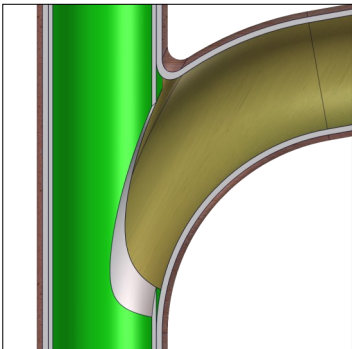

OPENED

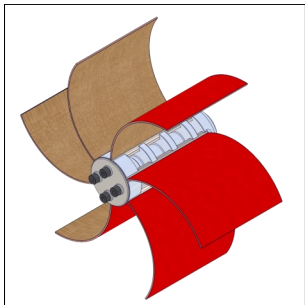

Smart Cutter™+

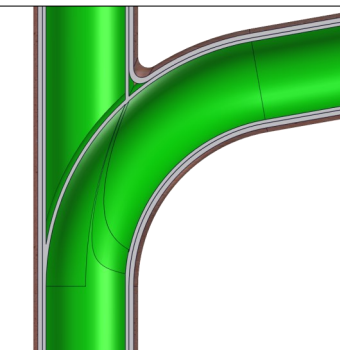

LINED

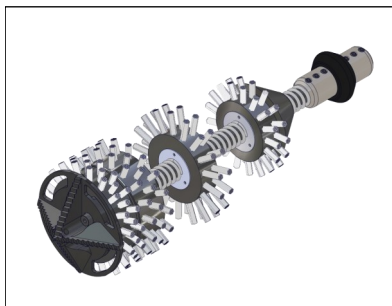

Twister+

SPECIAL

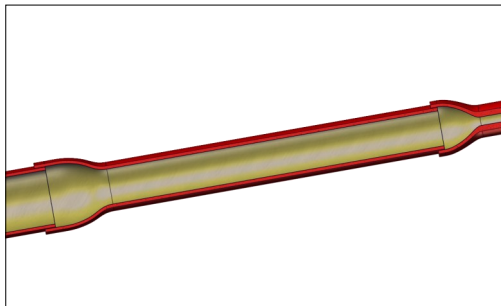

SIZE CHANGE

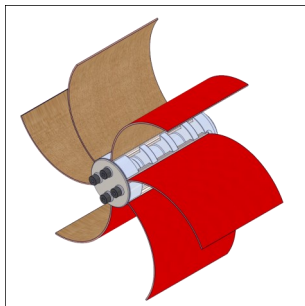

Smart Cutter™+

Maxi Miller Power+

Shaft Diameter: 18mm (3/4")

Range: 18 metres (60ft)

Additional Extension**: 11 metres (36ft)

**Can be used with 2 shaft extensions sold separately.

Recommended Diameter Range:

DN100 (4") Straight Pipes Only

DN150 (6") - DN300 (12")

Power Supply:

3-Phase, 400-480V, EU/UK: 16A USA:30A

Maxi Miller Power+

Available Tools

Twister+

Smart Cutter™+

Size Range

DN150 (6") - DN300 (12")

DN100 (4") - DN300 (12")