



TECHNICAL BULLETIN

EDGING OPTIONS

TYPES OF EDGING

Six3Tile panels can be installed in a wide variety of environments. In many installations, tile panels will not need an edge piece, as they will end at a perpendicular wall, under a kitchen cabinet or against a door jam. But there are numerous applications which will result with an exposed edge, which include

- Outside corner or edge
- Top edge
- Transitional area to another type of material

In some cases, grout or caulk will suffice - for example, the inside corner of a shower/tub surround or the bottom of a kitchen backsplash where it meets the countertop - and may be preferable for a quick, finished look. But there are also third-party options that are quick and easy to install.

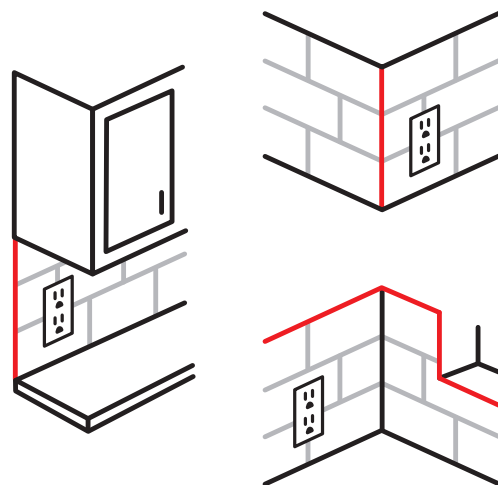

Brushed aluminum outside edge



PVC top edge

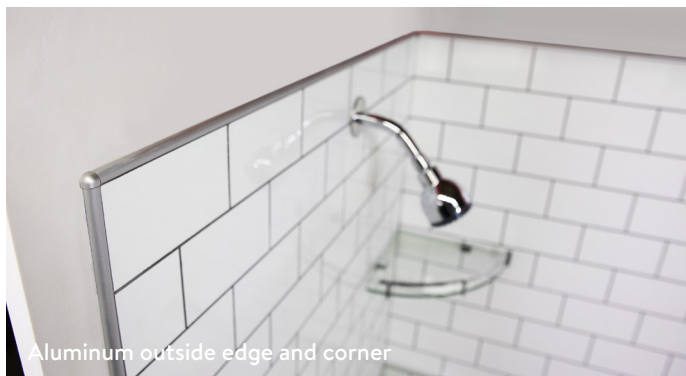

Aluminum outside edge and corner

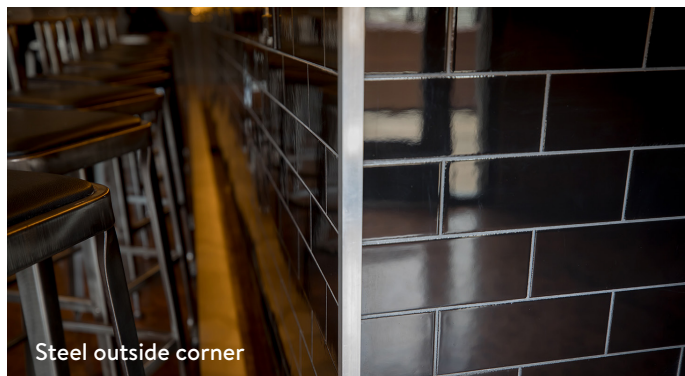

Steel outside corner

INSTALLING EXPOSED EDGE TRIM

Installing trim on an exposed end - whether the sides or the top - should be done at the time of tile panel installation.

1. Determine length and cut trim to fit.
2. Use a small amount of adhesive to hold trim piece in place.
3. Place pre-cut and pre-glued tile on wall - this should be the last tile sheet to be installed.
4. Position and press firmly into place, making sure the edge of the tile is covered by the edge trim.

TILE THICKNESS	EDGE TRIM PROFILE
6mm (.236")	8mm 5/16" (.3125")
4mm (.157")	6mm 1/4" (.25")
OTHER	add 1/8" from tile thickness to calculate edge trim profile size

Edge trim can also be installed AFTER the final tile panel is in place. Mount the tile panel and ensure adhesive is applied to the edge of the panel. Press the edge trim's tab behind the tile. After trim is in place, press the tile against the wall to ensure the bond is strong.

EDGE TRIM INSTALLED BEFORE TILE

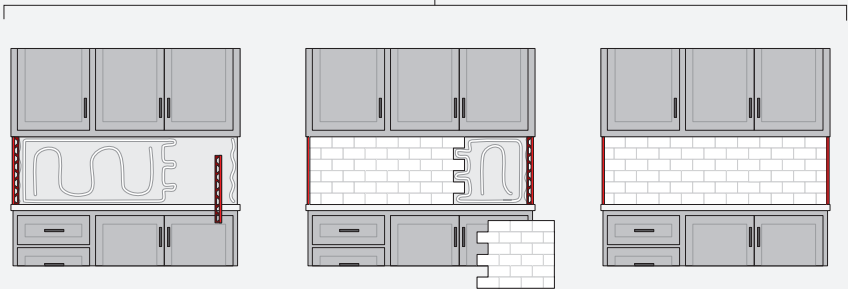

EDGE TRIM INSTALLED AFTER TILE

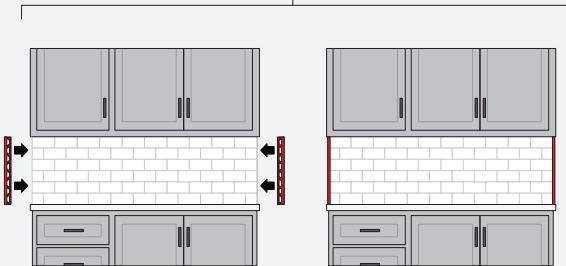

OTHER CONSIDERATIONS

EDGES OVER EXISTING TILE

The choice of edge options are somewhat limited when installing Six3Tile over existing tile. If the previous tile is cemented to the wall, the use of the slide-behind type of edging will not be possible. Only the outside corner style of edging can be used. When selecting the size of the edging, take into account the added depth of the existing tile behind the new tile panel. A larger L-shape depth may be required.

Outside corner edging (L-shape) can be installed using heavy duty construction adhesive.

CORNERS: MITRE CUTS VS. INSERTS

Edge trim can be easily cut with a mitre saw or by using a 45° speed square. Many styles of metal edge trim allow optional inside and outside corner trim pieces. This eliminates the need for mitre cuts and may offer a more upscale look.

WET APPLICATIONS

Consider using waterproof caulk or silicone with any edge trim used in wet applications, such as Tub Surrounds or Showers. This will help prevent water and moisture from penetrating the trim to the substrate behind the Six3Tile panels.

