

# imageRUNNER ADVANCE DX C5800 SERIES PRODUCT HANDBOOK



## **imageRUNNER ADVANCE DX C5870i / C5860i C5850i / C5840i**

imageRUNNER ADVANCE DX C5870i: Up to 70 ppm (BW/Color, LTR)

imageRUNNER ADVANCE DX C5860i: Up to 60 ppm (BW/Color, LTR)

imageRUNNER ADVANCE DX C5850i: Up to 50 ppm (BW/Color, LTR)

imageRUNNER ADVANCE DX C5840i: Up to 40 ppm (BW/Color, LTR)

TABLE OF CONTENTS

- [imageRUNNER ADVANCE DX Overview.....](#) 3
- [Target Market, Customer Needs, and Environment.....](#) 4
- [High-Speed Color MFP Positioning.....](#) 7
- [Key Product Sales Points.....](#) 8
- [Product Design Highlights.....](#) 26
- [imageRUNNER ADVANCE Value Pillars.....](#) 29
- [Configurations and Accessories.....](#) 30
- [Power Requirements and Dimensions.....](#) 31
- [iR ADV DX C5800 Series vs Predecessor Models.....](#) 32
- [Productivity Chart.....](#) 34
- [Item List, Country of Origin, and Compatibility.....](#) 42

## imageRUNNER ADVANCE DX OVERVIEW



***Supporting customers' digital transformation initiatives through advanced scan functionality and cloud-ready capabilities.***

### Simplify



The power to streamline user workflows and ease the implementation and management of technology

- Easy, Intuitive, and Consistent
- Customized Experience
- Integrating Workflows And Access to Cloud
- Centrally Manage a Fleet
- High Quality and Durability for Hassle-Free Uptime
- Easy To Set Up, Easy To Maintain

### Control



The power to take command of costs, manage print usage, and implement a secure solution

- Data and Network Security
- Security Management
- Monitor Usage and Control Costs

### Evolve



The power to expand capabilities and stay ahead of change

- Full Suite of Workflow Solutions
- Continuous Improvements
- Embedded App Development
- A Clean, Bright Future for All

The imageRUNNER ADVANCE DX C5800 Series replaces the existing imageRUNNER ADVANCE C5700 Series, with models within Dataquest Segment 3 color and Segment 4 color. The imageRUNNER ADVANCE DX C5800 Series models were designed as reliable, durable products that can easily integrate with Canon's holistic business solutions. When designing this product, a strong emphasis was placed on ease of use, outstanding image quality, fast color in a compact size, and a focus on authentication.

The target markets for the imageRUNNER ADVANCE DX C5800 Series are small- to mid-size offices that require quality color in a compact size as well as departments within large enterprises, where a fleet of imageRUNNER ADVANCE DX C5800 Series systems combined with other imageRUNNER ADVANCE models provide a strong solution with consistent usability. Enhancements to the Third Generation imageRUNNER ADVANCE platform with the launch of imageRUNNER ADVANCE DX platform also make these models an appropriate fit for environments that require a mobile workflow.

Within the Canon color line-up, the imageRUNNER ADVANCE DX C5800 Series falls between the imageRUNNER ADVANCE DX C3700 Series and the imageRUNNER ADVANCE DX C7700 Series. The imageRUNNER ADVANCE DX C3700 Series consists of two color A3 models supporting lower print volumes at speeds of up to 30/25 ppm. The imageRUNNER ADVANCE DX C7700 Series consists of three color A3 models supporting higher print volumes at faster speeds (up to 80/70 ppm) and offer more robust paper handling and finishing options.

See the following pages for positioning lineup charts and key differentiators that may help guide the selection of the right product for a specific customer.

Series	Model	Speed* (BW/Color, LTR)	Dataquest Segment	Optimum Zone	Max. Volume**
iR ADV C5800 DX Series	iR ADV DX 5870i	Up to 70 ppm	Segment 4	14-80K	350K
	iR ADV DX 5860i	Up to 60 ppm	Segment 4	12-60K	300K
	iR ADV DX C5850i	Up to 50 ppm	Segment 3	10-50K	230K
	iR ADV DX C5840i	Up to 40 ppm	Segment 3	5-45K	170K

\* Print speed is based on internal testing. Print speed may vary depending on the number of copies selected, as well as on the settings for size, type, and orientation of paper.

\*\* The maximum monthly volume (print/copy) represents the maximum number of pages the machine can produce within a one month period. It is not recommended to operate the machine at or beyond this volume on a consistent monthly basis.

## PRODUCT POSITIONING

The following pages include lineup overviews and differentiators that may help guide the selection of the right product for a specific customer.

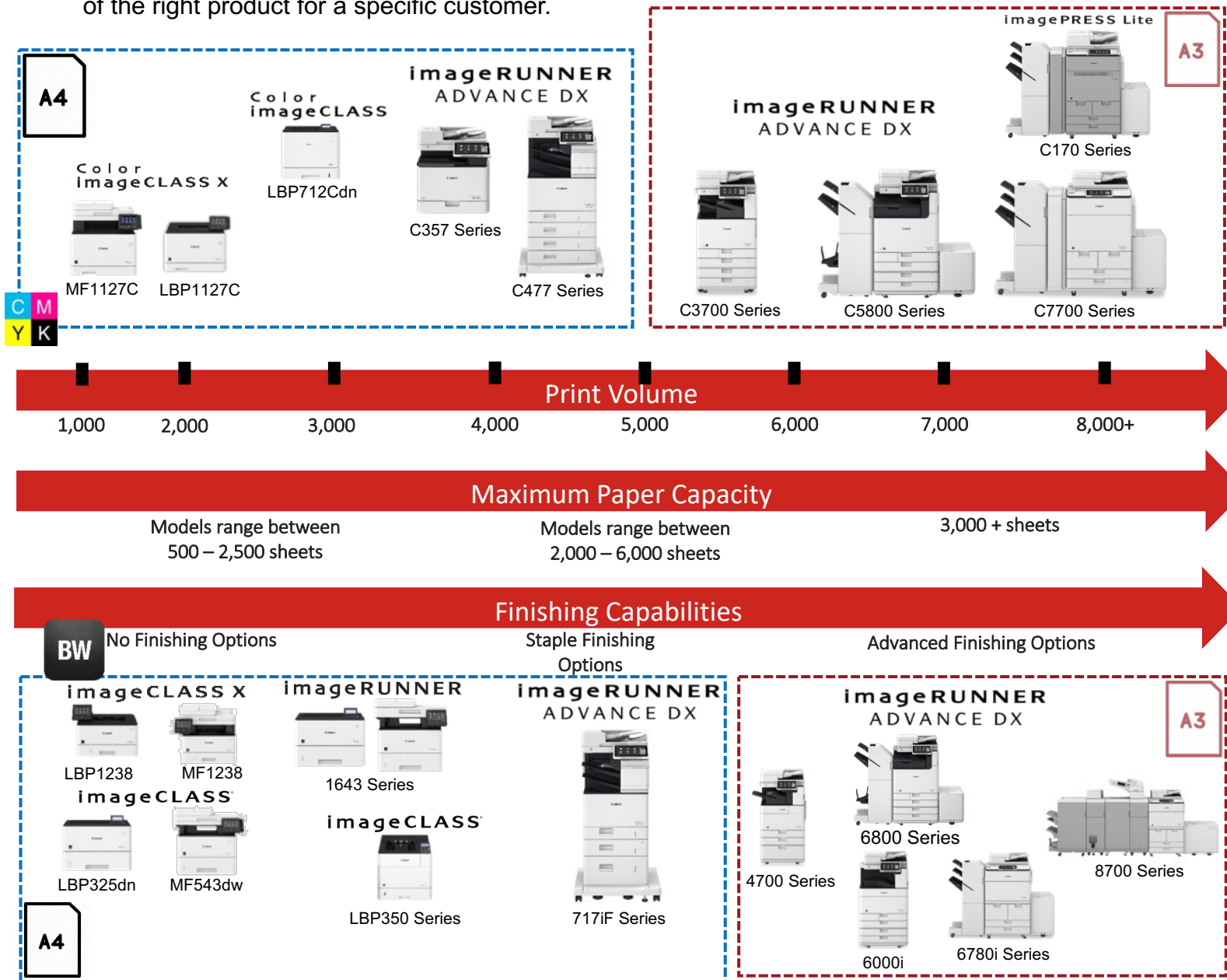

### Device Spotlight

- **Print Volume** – 5-80K
- **Maximum Paper Capacity** – 6,350 Sheets
- **Finishing Options** – Staple/Booklet/Inner Finisher with Hole Puncher
- **Security Features**- McAfee Embedded Control, SIEM Integration, SSD Security
- **Native Device Storage**- Mail Box/Advance Box features

**imageRUNNER**  
ADVANCE DX  
**C5870i/C5860i**  
**C5850i/C5840i**

# TARGET MARKET, CUSTOMER NEEDS, AND ENVIRONMENT

**imageRUNNER**  
ADVANCE DX

	imageRUNNER ADVANCE DX C3700 Series	imageRUNNER ADVANCE DX C5800 Series	imageRUNNER ADVANCE DX C7700 Series
<b>Copy/Print Speed*</b> (BW/Color, LTR)	Up to 30/30, 25/25 ppm	Up to 70/70, 60/60, 50/50, 40/40 ppm	Up to Up to 80/70, 70/65, 65/60 ppm
<b>Optimum Zone</b>	2-16K	5-80K	15-120K
<b>Max. Volume**</b>	110K	350K	390K
<b>Supported Finishing Options</b>	Booklets, 2/3-Hole Punching (Punching w/ External Finisher)	Adds... Booklets, 2/3-Hole Punching (Punching w/ External and Internal Finishers ■)	Adds... Document Insertion, Folding (Z, C, Half, Accordion Z, Double-parallel), Professional Punching
<b>Max. Output Capacity (w/ finisher)</b>	3,450 sheets		4,250 Sheets
<b>Max. Paper Capacity</b>	2,300 sheets through 5 sources	6,350 sheets through 6 sources	9,300 sheets through 7 sources
<b>Max. Paper Size</b>	12-5/8" x 18"		13" x 19-1/4"
<b>Max. Paper Weight (Cassettes)</b>	80 lb. Cover (220 g/m <sup>2</sup> )	140 lb. Index (256 g/m <sup>2</sup> )	Paper Cassettes: 140 lb. Index (256 g/m <sup>2</sup> ) Paper Decks: 80lb. Bond (220 g/m <sup>2</sup> )
<b>Max. Paper Weight (Stack Bypass)</b>	110 lb. Cover (300 g/m <sup>2</sup> )		
<b>Document Feeder Capacity</b>	Up to 200 sheets		
<b>ADF Scan Speed</b>	Up to 270 ipm (300 dpi)	Up to 270 ipm (300 dpi)	Up to 270 ipm (300 dpi)
<b>Control Panel</b>	10.1" Flat Panel Color WSVGA	10.1" Flat Panel Color WSVGA	Standard: 10.1" Flat Panel Color WSVGA Optional: 10.4" Upright Color SVGA
<b>Small Footprint Configuration (Inner Finisher)</b>	✓	✓	-
<b>Power Requirements</b>	110V-127V, 60Hz, 7.5A	C5870i/C5860i/C5850i: 110-127V, 60Hz, 12A C5840i: 110-127V, 60Hz, 10A	C7780i: 208-240V 60Hz 12A C7770i/C7765i: 110-127V 60Hz 16A

\* Print speed is based on internal testing. Print speed may vary depending on the number of copies selected, as well as on the settings for size, type, and orientation of paper.

\*\* The maximum monthly volume (print/copy) represents the maximum number of pages the machine can produce within a one-month period. It is not recommended to operate the machine at or beyond this volume on a consistent monthly basis.

■ Inner Finishers not available for C5870i.

**Canon**

# High-Speed Color MFP Positioning

	imageRUNNER ADVANCE DX C5800 Series	imageRUNNER ADVANCE DX C7700 Series	imagePRESS Lite C170 Series
<b>Copy/Print Speed (BW/Color, LTR)</b>	Up to 70/70, 60/60, 50/50, 40/40 ppm	Up to Up to 80/70, 70/65, 65/60 ppm	Up to Up to 80/70, 65/65 ppm
<b>Resolution</b>	1200 x 1200 dpi	2400 x 2400 dpi	2400 x 2400 dpi
<b>Image Quality</b>	★★★★★	★★★★★	★★★★★
<b>FCOT (BW/Color)</b>	As fast as 2.7/3.7 seconds As fast as 2.9/4.2 seconds As fast as 3.4/4.9 seconds As fast as 4.1/6.1 seconds	C7780i: As fast as 4.4/5.4 seconds C7770i: As fast as 4.8/5.9 seconds C7765i: As fast as 4.8/5.9 seconds	C170: As fast as 4.8/5.9 seconds C165: As fast as 4.4/5.4 seconds
<b>Optimum Zone</b>	5-80K	15-120K	15-100K
<b>Max. Volume*</b>	350K	390K	390K
<b>Supported Finishing Options</b>	Adds... Booklets, 2/3-Hole Punching (Punching w/ External and Internal Finishers)	Adds... Document Insertion, Folding (Z, C, Half, Accordion Z, Double-parallel), Professional Punching	Adds... Advanced finishing options incl. Document Insertion, Folding (Z, C, Half, Accordion Z, Double-parallel), Professional Punching
<b>Max. Output Capacity (w/ finisher)</b>	Up to 3,450 sheets	Up to 4,250 Sheets	Up to 5,000 Sheets
<b>Max. Paper Capacity</b>	Up to 6,350 Sheets	Up to 9,300 Sheets	Up to 7,050 Sheets
<b>Max. Paper Size</b>	12-5/8" x 18"	13" x 19-1/4"	13" x 51.2"
<b>Max. Paper Weight (Cassettes)</b>	140 lb. Index (256 g/m <sup>2</sup> )	Paper Cassettes: 140 lb. Index (256 g/m <sup>2</sup> ) Paper Decks: 80lb. Bond (220 g/m <sup>2</sup> )	Paper Drawer: up to 110lb Cover (300g/m <sup>2</sup> ) Stack Bypass: up to 129lb cover (350 g/m <sup>2</sup> )
<b>Max. Paper Weight (Stack Bypass)</b>	110 lb. Cover (300 g/m <sup>2</sup> )		130 lb. Cover (350 g/m <sup>2</sup> )
<b>Accepted Originals</b>	Duplex: 52-256gsm Simplex: 300gsm	Duplex: 52-220gsm Simplex: 300gsm	Duplex: 52-220gsm Simplex: 350gsm
<b>Document Feeder Capacity</b>	Up to 200 sheets		
<b>ADF Scan Speed</b>	Up to 270 ipm (300 dpi)	Up to 270 ipm (300 dpi)	Up to 240 ipm (300 dpi)
<b>Standard Control Panel</b>	10.1" Flat Panel Color WSVGA	Standard: 10.1" Flat Panel Color WSVGA Optional: 10.4" Upright Color SVGA	
<b>External Controllers</b>	imagePASS-R1	imagePASS-N2	imagePRESS Server L30 V2 (External) and M10 V2 (Embedded)
<b>Power Requirements</b>	C5870i/C5860i/C5850i: 110-127V, 60Hz, 12A C5840i: 110-127V, 60Hz, 10A	C7780i: 208-240V 60Hz, 12A C7770i/C7765i: 110-127V 60Hz, 16A	C170: 208-240V 60Hz, 12A C165: 120-127 V AC, 60 Hz, 16A
<b>Plug Requirements</b>	NEMA 5-15P	NEMA 5-20P	C170: NEMA 6-15P C165: NEMA 5-20P
<b>TEC Value</b>	C5870i: 0.86 kWh C5860i: 0.71 kWh C5850i: 0.57 kWh C5840i: 0.47 kWh	C7780i: 1.35 kWh C7770i: 1.19 kWh C7765i: 1.14 kWh	C170: 1.39 kWh C165: 1.21 kWh

\*The maximum monthly volume (print/copy) represents the maximum number of pages the machine can produce within a one month period. It is not recommended to operate the machine at or beyond this volume on a consistent monthly basis.

## KEY PRODUCT SALES POINTS

- **imageRUNNER ADVANCE DX Platform**

The imageRUNNER ADVANCE DX C5800 Series has a strong feature set focused on Workflow Efficiency, Device & Fleet Management Efficiency, Security, Cost Management, Sustainability, and Reliability.

For more information about all of the features available with the Third Generation imageRUNNER ADVANCE platform, see the Third Generation imageRUNNER ADVANCE and imageRUNNER ADVANCE DX Platform Handbook.

- **The imageRUNNER ADVANCE DX C5800 Series has a strong standard feature set including the following:**

Advanced  
Personalization  
with My ADVANCE

TPM 2.0

FTPS Support

TLS 1.3 Support

10.1 in Touch  
Screen  
w/ Soft-Keys

Fast Scan Speeds

uniFLOW Online  
Express

McAfee Embedded  
Control

Solid State Drive  
(SSD)

Universal Print  
by Microsoft

Remote Operation  
with Canon PRINT  
Business APP

Fast & Easy  
Replaceable Parts

## KEY PRODUCT SALES POINTS



## Features

### ✓ Flexible Authentication

Users are required to authenticate at the imageRUNNER ADVANCE system using a Proximity Card,\* PIN code, Image login and optional PIN Code, or Department ID.

### ✓ Secure Printing

Users' print jobs can be pulled to whichever networked imageRUNNER ADVANCE system they choose, and print jobs are only released when authenticating at the device.

### ✓ Print From Cloud

Users can now print from connected cloud services on connected Canon imageRUNNER ADVANCE devices. Supported cloud services include Box, Dropbox, Evernote®, Google Drive™, Microsoft OneDrive®/OneDrive® for Business and SharePoint® Online. Folder browsing and finishing options are supported.

### ✓ Secure Document Scanning

With uniFLOW Online users can scan documents directly from any connected Canon imageRUNNER ADVANCE. The lean and intuitive user interface plus single sign-on to the secure "Scan-to-Myself" and "Scan-to-Google Drive"™ workflows help to bring about gains in productivity. With an additional scan subscription, users can scan directly to the following cloud-based destinations: Box, Microsoft OneDrive®, Microsoft OneDrive® for Business, Evernote®, Microsoft SharePoint® Online, Dropbox, and Concur®.

### ✓ Send Print Jobs From Anywhere

Users can submit print jobs from their networked, compatible PCs, smartphones, tablets, or the Mobile Print & Scan App, and print job submissions will follow them from one compatible device to another.

### ✓ Cloud-based Infrastructure

There's no requirement for local uniFLOW servers, and configuration and management of the system takes place in the cloud.

### ✓ Track Print, Scan, Copy, and Fax Costs

Administrators can use the comprehensive uniFLOW Online Dashboard to view valuable analytical information. Device activity costs can be allocated to users or departments. If needed, administrators can even create different projects or cases under the cost center menu so that users can charge their print, scan, or copy charges accordingly.

\* imageRUNNER ADVANCE systems, Universal Login Manager, Proximity Card Readers, and Cards are sold separately. uniFLOW online is optional for imageRUNNER ADVANCE devices. .

## KEY PRODUCT SALES POINTS

- Display Configuration**

The 10.1" WSVGA fully flat touch display includes a soft-key numeric pad. This compact, full-touch design allows for easy access to internal trays and an optional card reader.

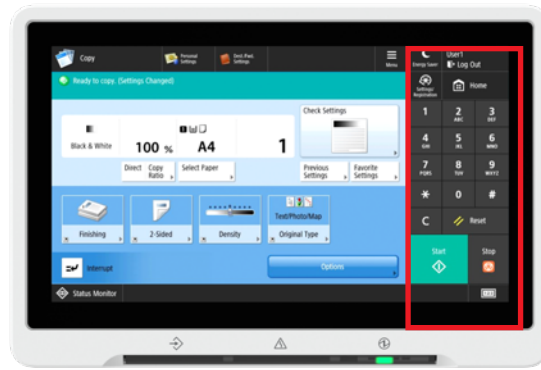

Soft-Keys

- Usability**

With the introduction of UFP v3.12, imageRUNNER ADVANCE devices support 4 Medium/Small-sized button layout and function shortcut keys for swift access to frequently used functions.

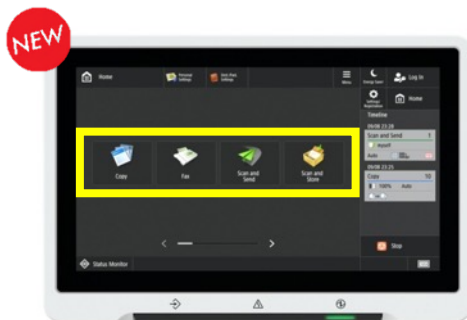

4 MS-sized button layout

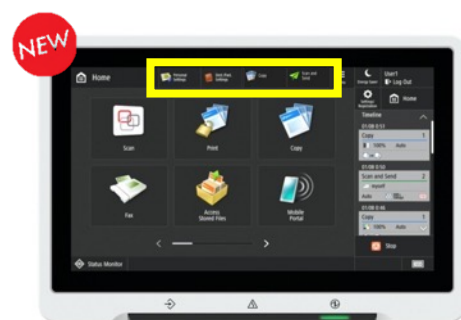

Function Shortcuts

- Card Reader Placement**

Optional Card Reader controls access to the device and specific features when using a proximity card.



**Note:**

10 Card reader sold separately.

## KEY PRODUCT SALES POINTS

- **Intuitive User Interface**

10.1" WSVGA fully-flat adjustable tilt control panel with flick, pinch, and drag and drop operability\*. Soft-key user interface provides familiar smartphone like functionality with operational keypad built into the touchscreen UI.

- **Home Screen**

With the introduction of the imageRUNNER ADVANCE DX models, on screen soft-key support is now standard. The specifications of the local UI include timeline support and consolidated Main Menu and Quick Menu screens into one "Home" screen. The Home screen is comprised of Main Menu buttons and Timeline. Support for long presses for improved operability and customization for users and administrators.

User Interface



Flick\*



Pinch

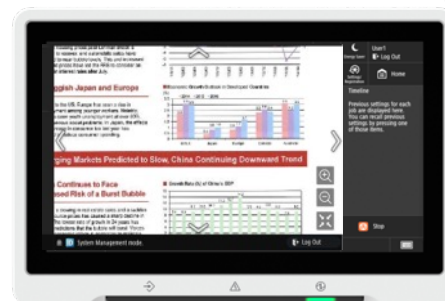

**Note:**

User interface feature Timeline, only available on III edition and DX models.

\*Flick is not available on the following screens: one touch menu, [Options] menu in Copy/Box/Send, Settings/Registration.

Pinch can be used on any menu or function screen. Default is off, and can be turned on in Settings/Registration → Preferences → Accessibility Settings → Enable Screen Magnification. Drag and Drop to rearrange the button layout in the Quick Menu. Toggle on-off in the bottom right corner.

## KEY PRODUCT SALES POINTS

### Home Screen with Timeline

- Home Screen is an integrated menu, combining the Main Menu and Quick Menu to help provide users with increased workflow efficiency and personalization. Available with third generation imageRUNNER ADVANCE 3rd edition and DX models.
- The main menu gear icon is a collapsed menu icon, from which display settings related to the screen the user is currently on can be accessed.

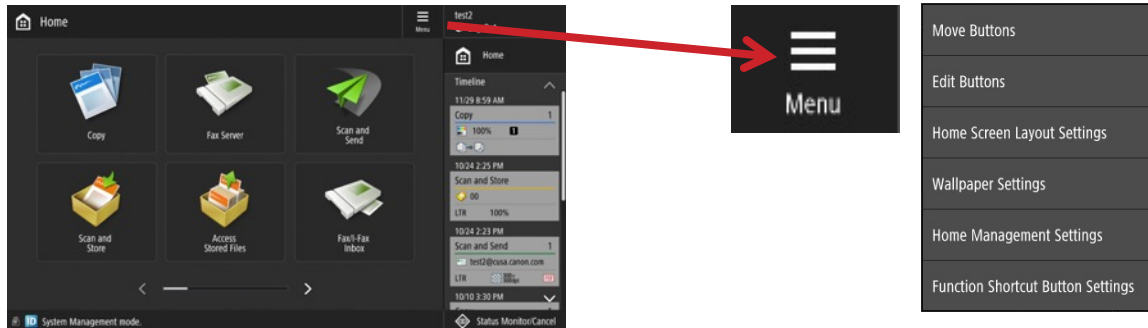

- The Home screen consists of two sections – the integrated menu and the Timeline. The integrated menu includes the function buttons (Copy, Scan and Send, Access Stored Files, etc.) as well as Quick Buttons. Quick Buttons can either be Personal (integrating with My ADVANCE) or Shared and accessed directly from the Home Screen.

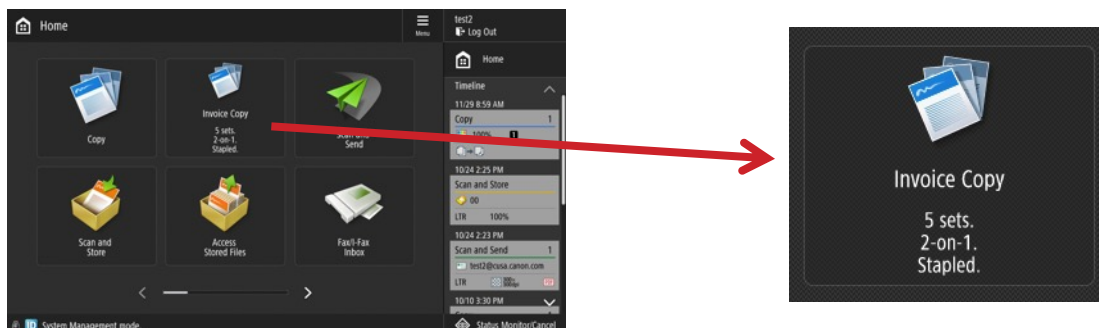

- Timeline allows you to easily recall 10 of the most previous jobs or functions (Copy, Scan and Send, Access and Stored Files\*). With the introduction of UFP v3.10, you can easily recall saved files from locations local to the device.\*\*

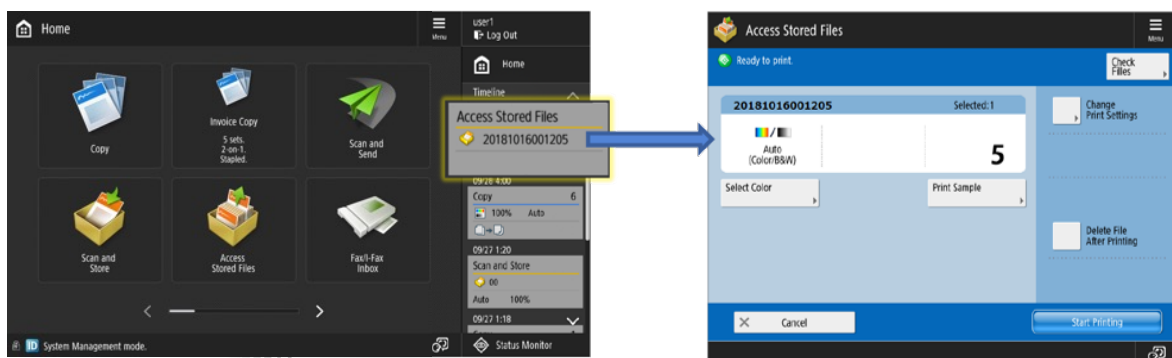

\*Access and Stored files available from UFP v3.10.

\*\*Limited to III edition and DX model devices.

## KEY PRODUCT SALES POINTS

### Advanced Personalization with My ADVANCE

My ADVANCE offers a personalized user experience at the device optimized for the workflow of each individual user when used with a log-in service, such as the standard Universal Login Manager solution. This feature provides the ability to customize displays, settings, and functions for individual users' preferences and workflows.

- **My Display:** Customize your display language, initial screen, and accessibility settings. Access your own job status and job history.
- **My Settings:** Improve efficiency with your personal default settings and previous settings. Access your own personal Quick Menu. Ease the log-in process with keychain authentication.
- **My Function:** Access your own personal address book and Secure Print jobs. Easily send to yourself or a personal folder.

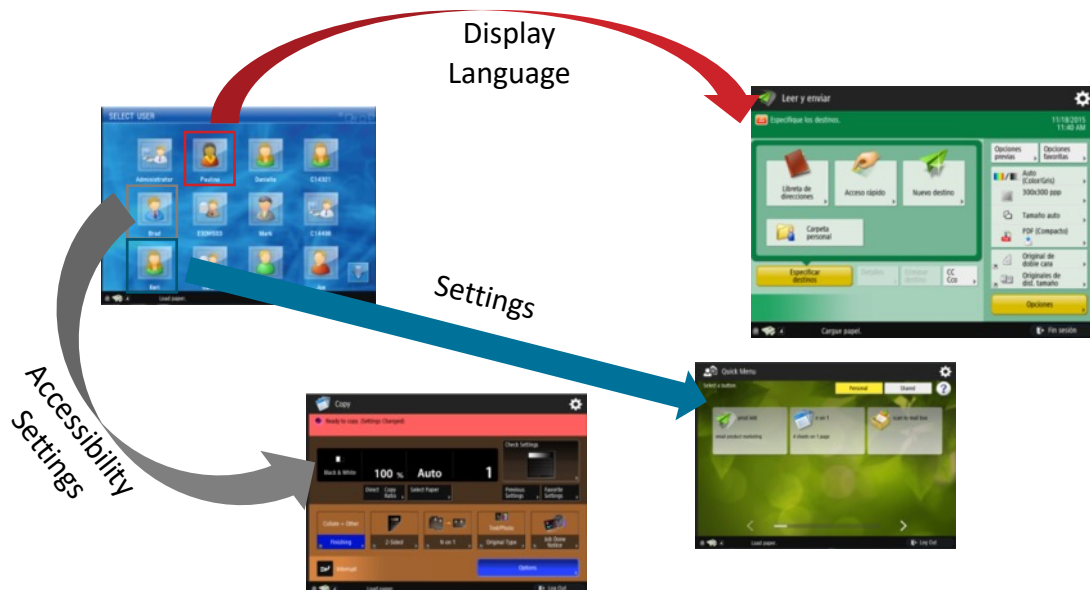

User preferences set with My ADVANCE can be synchronized in real-time (up to 10 compatible devices) so that changes made to personal settings will be replicated across the specified Third Generation imageRUNNER ADVANCE and imageRUNNER ADVANCE DX devices.



For more information on My ADVANCE, including which settings can be customized by user, details on synchronization, and certain limitations, see the Third Generation imageRUNNER ADVANCE and imageRUNNER ADVANCE DX Platform Handbook.

## KEY PRODUCT SALES POINTS

### Automatic Document Feeder

#### Sleek Tray Design

**Black tray** for better paper visibility

**Flat top** for placing documents

#### Benefits:

- **FAST** for productivity
- **QUIET** for integration in environments that require little noise
- **SMART** technology for better user experience

### Scan Speed\*

up to **270 ipm**

**As fast as 4.5 sheets per second!**

(BW/Color, LTR, Duplex)

### ADF Paper Capacity (20 lb Bond)

**200** Sheets



**Note:** Card reader sold separately.

\* Examples based on typical settings, rated in pages/images per minute with letter-sized documents, [Insert landscape or portrait] feeding direction, up to [INSERT dpi] dpi. Actual processing speeds may vary based on PC performance and application software.

## KEY PRODUCT SALES POINTS

### Easy and Fast Replaceable Parts

Minimizing the need for tools and screws makes key parts fast and easy to replace.

#### imageRUNNER ADVANCE DX C5700 Series

#### imageRUNNER ADVANCE DX C5800 Series

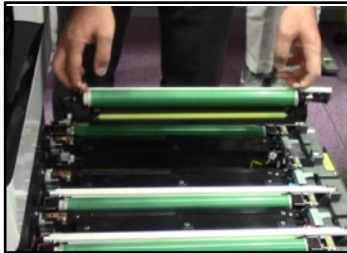

NEW

DRUM

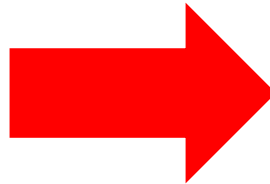

NO TOOLS  
REQUIRED

Approx. **2 minutes**  
Number of screws: **5**

**NOW** Approx. **30 seconds**  
Number of screws: **0**

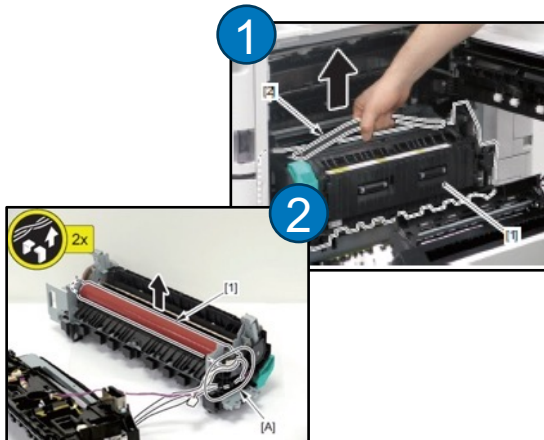

NEW

Fixing  
Assembly

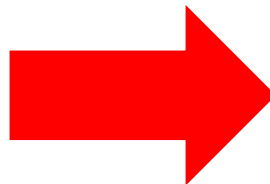

NO TOOLS  
REQUIRED

Approx. **2 minutes**  
Number of screws: **5**

**NOW** Approx. **20 seconds**  
Number of screws: **0**



NEW

ITB

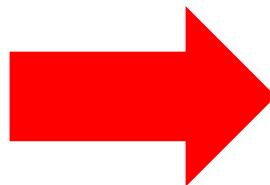

Approx. **2 minutes** to replace  
Number of screws: **5**

**NOW** Approx. **50 seconds**  
Number of screws: **1**

*Time shown does not include the process of separating the ITB cleaning unit from the ITB unit.*

**Note:**

- Times may vary
- Compared to predecessor model

## KEY PRODUCT SALES POINTS

### Automatic Document Feeder

- Wide Range of Media Support**

The imageRUNNER ADVANCE DX C5800 Series supports additional media sizes through the ADF to expand support for documents such as receipts and checks. The Free Size setting allows for the accurate scanned file dimension size for these types of documents.

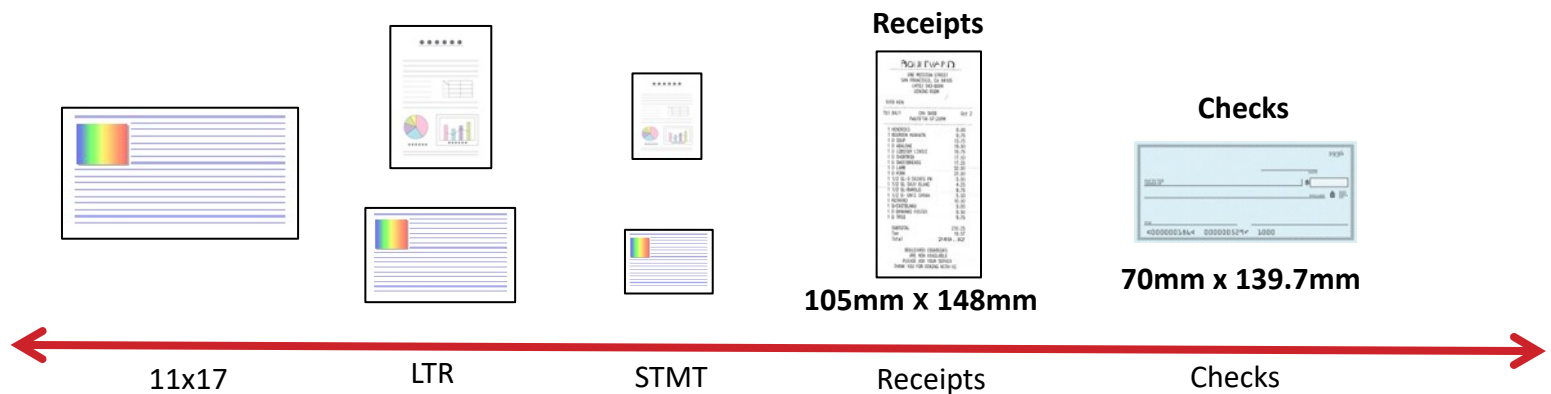

- Digital Skew Correction**

The imageRUNNER ADVANCE DX C5800 Series utilizes digital skew correction that helps increase scan accuracy and helps enable fast scan speeds.

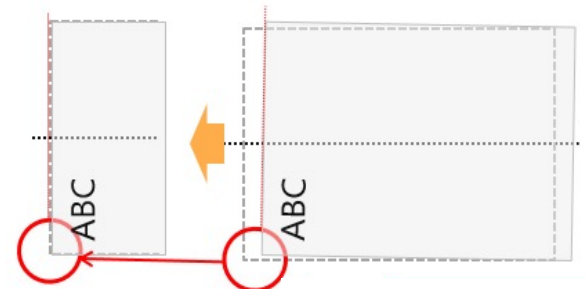

- Stain-Resistant Coating for ADF Scanning Glass**

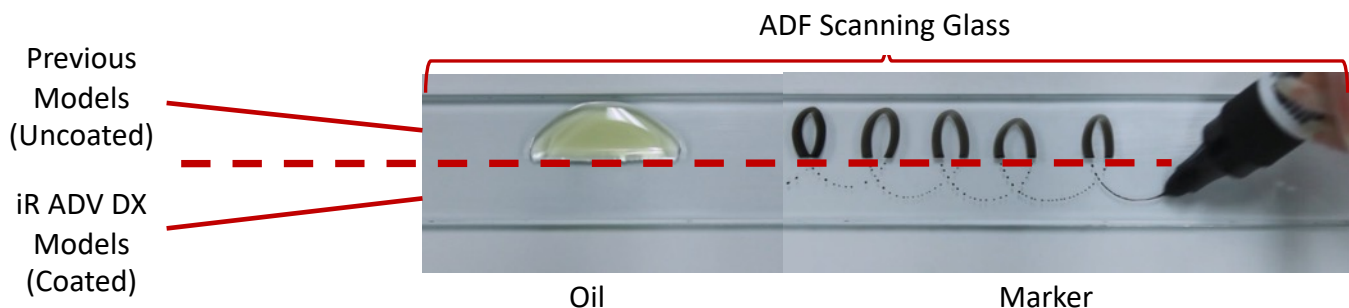

## KEY PRODUCT SALES POINTS

- Toner Specifications**

All models of the imageRUNNER ADVANCE DX C5800 Series use the same toner – GPR-61. This is a new toner being introduced with this series. The toner yields help provide high productivity, and efficiency.

imageRUNNER ADVANCE DX C5800 Series

	GPR-61	GPR-61L
Black	<u>71,000</u>	N/A
Cyan	<u>60,000</u>	26,000
Magenta	<u>60,000</u>	26,000
Yellow	<u>60,000</u>	26,000

### Common Toner = Reduce Stock Space, Easy Inventory Management

The imageRUNNER ADVANCE DX C5800 Series support a lower yield, or “L,” color toner. Possible uses for this toner include lowering the initial installation cost, decreasing the cost of the last toner bottles on a lease, and providing more flexibility for managing toner costs for low usage customers (low copy volume/low color usage).

**Note:**

All yields are estimated at 5% coverage.

## KEY PRODUCT SALES POINTS

### Verify System at Startup

- Verify System at Startup is a process to help verify the validity of the device BIOS (Basic Input/Output System), firmware, and MEAP applications from unauthorized modifications.
- This functionality adds to that already provided by previous imageRUNNER ADVANCE models, which also include a number of security measures to help protect the integrity of the device, firmware, and MEAP applications

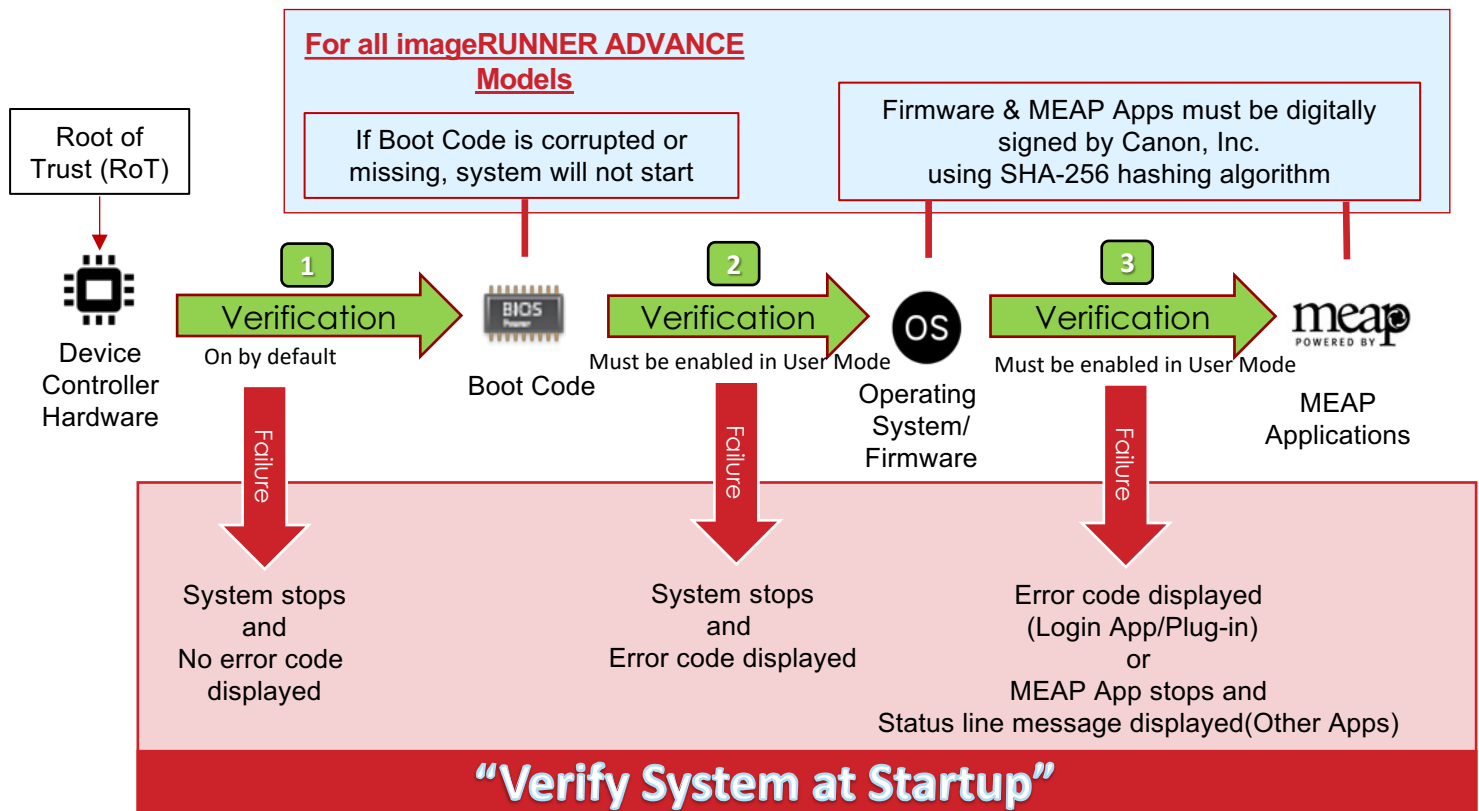

User Mode: Setting/Registration>Device Settings>Management Settings>Security Settings>Verify System at Startup

#### Note:

- Performed at every device reboot.
- This function is OFF by default. It can be turned on by an administrator in Settings/Registration.
- When activated, device warm-up time will increase by 20-40 seconds (depending on model). Recovery from Sleep mode is not affected.
- Error code will require a service call to remediate.
- Only available on imageRUNNER ADVANCE III edition and imageRUNNER ADVANCE DX models.

## KEY PRODUCT SALES POINTS

**McAfee Embedded Control™**

- While **[Verify System at Startup]** comes standard with all 3rd Edition and DX models (with Unified Firmware Platform v3.8 or later), UFP v3.9 introduced this additional layer of MFP security.
- McAfee Embedded Control is standard on all third generation imageRUNNER ADVANCE 3<sup>rd</sup> edition and imageRUNNER ADVANCE DX models from firmware v3.9.
- Designed to prevent malware execution and tampering of firmware and applications.
- With McAfee Embedded Control, all firmware and applications are checked against a whitelist that only allows approved firmware and applications determined by Canon to be executed. Helping to prevent unauthorized changes to the system. This whitelist is automatically updated with UFP updates as well as during updates/installations of individual MEAP applications.



- **Whitelisting** prohibits execution of unknown software by only allowing trusted firmware and applications to execute. Therefore, the whitelist function is able to help prevent an unknown malware launch, and mitigate zero-day attacks. Zero day attacks can exploit previously unknown vulnerabilities before they can be patched by the manufacturer.
- Denied unauthorized program tampering and unauthorized executions are recorded to the audit log, enabling administrators to check the device status through syslog and audit log functions.

**NOTE:**

This function is set to [OFF] by default

- In order to set this function to ON, [Verify System at Startup] also needs to be set to ON.
- When this function is set to ON, device startup will take slightly longer (does not affect sleep recovery/Quick Startup time).



### Advanced Device Security

Our imageRUNNER ADVANCE DX devices are strong in the area of security with many standard security features designed to help protect data from various aspects of network, device, and document security.



### • **NEW** Trusted Platform Module(TPM) 2.0

TPM is a security chip that is responsible for encrypting and decrypting critical data such as passwords, certificates, and encryption keys. Compared to previous TPM, the TPM 2.0 will support stronger encryption technology that can help protect critical data in MFPs.

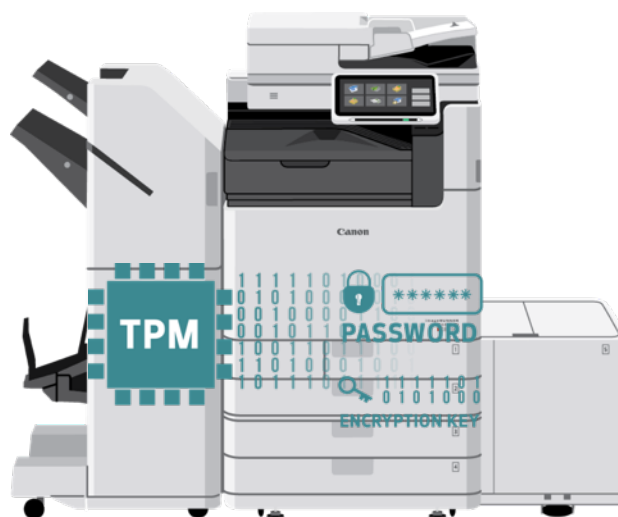

## KEY PRODUCT SALES POINTS

### Improved Speed and Durability with Solid-State Drive (SSD)

With the imageRUNNER ADVANCE DX C5800 Series, Solid-State Drive (SSD) will be replacing Hard Disk Drive (HDD) as the standard data storage.

- **Basic Information**

- Standard Storage of 256GB
- Additional Storage option - 250GB/1TB/Mirroring Kit available
- Delete per job and HDD Erase Scheduler are not supported with SSD

**Improved  
SPEED &  
DURABILITY  
with SSD**



- ✓ Exceptionally fast which provide quicker startup time
- ✓ More resilient; it is less likely for it to fail
- ✓ No moving parts making it vibration and shock-resistant
- ✓ Mean time before failure for SSD is approximately 3x longer than HDD reducing replacement costs.

- **SSD Data Control**

- Data writes in pages and groups data in blocks
- Limited writes per cell on SSD
- Process replaces the previous HDD Data Erase feature on predecessor models

#### TRIM Command

The engine OS sends a TRIM to mark the PAGE(s) of data that were deleted as Erased.

#### Garbage Collection

Process where the SSD moves valid PAGE(s) out the BLOCK to another BLOCK and wipes the BLOCK (Electrically Intensive)

- **Strong Security Protecting Data on SSD**

Password Lock	Data Encryption	Data Initialization
<ul style="list-style-type: none"> <li>• SSD is secured with a password designed to ensure that only that unit (and not a PC, for example) can read from or write to the drive</li> </ul>	<ul style="list-style-type: none"> <li>• AES-XTS 256-bit encryption – “strongest AES encryption standard”*</li> <li>• Canon MFP Security Chip complies with the FIPS 140-2 Level 2 (U.S. government standard)</li> </ul>	<ul style="list-style-type: none"> <li>• Overwrites the stored data at end of lease – Only needed to write all ‘0’ one time</li> </ul>

\* AES currently comes in 128-bit, 192-bit, and 256-bit implementations.

## KEY PRODUCT SALES POINTS

### Image Quality Highlights

#### IAP Toner Bottle

#### Stable Toner Supply

- The “Insulated & Air Pressure” Air Assist Method provides varied air pressure levels depending on the toner remaining in the bottle.
- Provides a stable toner supply, helping to contribute to outstanding image quality and consistency.

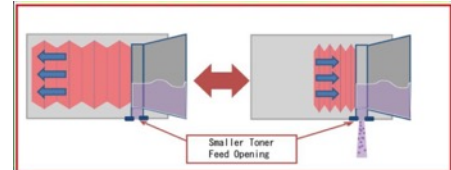

New

#### CS2 Toner

#### Quality on Rough Paper

#### Stable Color Quality

- Low-melting toner helps reduce electric power required for fixing.
- Results in fast print speeds and lower power consumption.
- Toner surface characteristics provide high transfer stability, helping to reduce irregularities and scattering.
- Durability, charging stability, and toner surface characteristics, combined with the image control abilities of the main unit, provides stable and consistent color output, even over long runs

Schematic cross-sectional view of toner

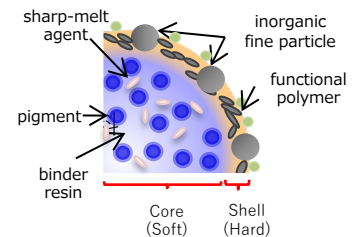

#### V<sup>2</sup> Color Profile

#### Vividness

#### Vibrance

- 20%\* Expanded color reproduction range (gamut) of the device
- Strong color reproduction in dark areas.
- Sharp clarity of documents, especially photos.
- Prints appear crisp and well-defined.

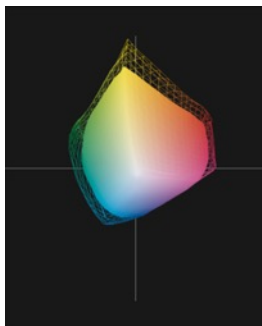

Solid : iR ADV C5200 Series  
Mesh: iR ADV C5500 Series



## KEY PRODUCT SALES POINTS

### • Paper Weight Support

The imageRUNNER ADVANCE DX C5800 Series support up to 110 lb. Cover (300 g/m<sup>2</sup>) from the multi-purpose tray and 16 lb bond to 140 lb cover (52 to 256 g/m<sup>2</sup>)



Up to 110 lb. Cover (300 g/m<sup>2</sup>)  
Multi-Purpose Tray

Up to 140 lb. Index (256 g/m<sup>2</sup>)  
Upper and lower cassettes

### • Fast Small Paper Printing

With the C5700 Series, overheating of the fixing film decreased the print speed for small paper. With the imageRUNNER ADVANCE DX C5800, the space between sheets is widened and fans are added for cooling. By preventing overheating of the fixing film, print speed does not decrease when a large amount of A5R/STMTR/B5R is outputted.

<b>B5</b>	70ppm
<b>B5R<sup>■</sup></b>	42ppm
<b>A5</b>	70ppm
<b>A5R<sup>■</sup></b>	70ppm
<b>STMTR<sup>*</sup></b>	60ppm <small>*STMTR is supported manual feed only (60 ppm)</small>
<b>STMTR<sup>■</sup></b>	70ppm

■ The higher speed is the rating for 90 g/m<sup>2</sup> paper in an operating environment of 73.4 degrees F (23 degrees C) and 50% humidity. Productivity may decrease when the temperature decreases below 73.4 F (23 C) or when the paper weight is above 90 g/m<sup>2</sup>.

**Note:** Speeds shown for 70ppm models



IR ADV DX  
C5700 Series

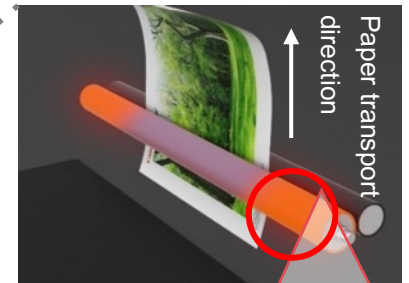

Previously, the edges were not cooled by the fan and did not dissipate heat because they did not pass through the paper.

## KEY PRODUCT SALES POINTS

- **Expanded Support for Mobile Workflows**

The imageRUNNER ADVANCE DX product line, as well as all third generation imageRUNNER ADVANCE models, support Apple AirPrint®, and Mopria®. With the standard Mobile Portal, these models are fully compatible with the Canon PRINT Business app. For more information, see the Third Generation imageRUNNER ADVANCE and imageRUNNER ADVANCE DX Platform Handbook.



- **Motion Sensor**

The main unit includes a motion sensor designed to reduce the perceived waiting time for the device to recover from sleep mode. The device is able to detect an approaching user, intelligently predict the user's intent, and recover from sleep mode accordingly. Likewise, the device can predict when the user is finished using the device and returns to sleep mode. Four sensitivity settings are available to suit varying operating environments and, if preferred, the motion sensor sleep trigger can be turned off entirely allowing the device to transition to and from sleep mode like predecessor models.



## KEY PRODUCT SALES POINTS

### Canon PRINT Business App

imageRUNNER  
ADVANCE DX



- **Remote Operation**

This feature allows users to controls the imageRUNNER ADVANCE user interface from a compatible smartphones or tablet without having to touch the control panel. With the goal of working more efficiently and safely, customers are looking for ways to continue leveraging their office multifunction printers while, at the same time, minimizing touchpoints.

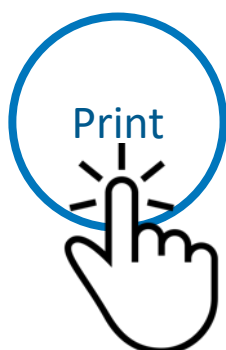

Print from your mobile device and supported cloud storage locations.\*

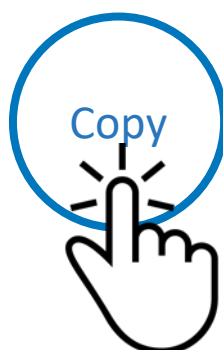

Use the Remote Operation feature to copy documents without touching the MFP control panel.

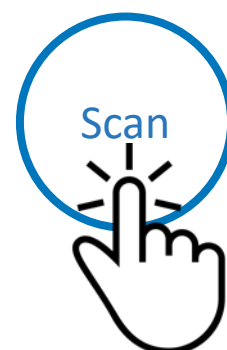

Scan and Send to your mobile device and store in supported cloud storage locations.\*

## PRODUCT DESIGN HIGHLIGHTS

- **Easy to Use Paper Cassettes with Soft Close Drawers**

The imageRUNNER ADVANCE DX C5800 Series, paper cassettes feature a handle – requiring only a simple pull motion to open. Changing paper is simple with easy-to-use guides. The device automatically recognizes the size of the loaded paper making changing paper stocks simple and easy. The paper cassettes also feature soft close drawers to help prevent noisy operation and slamming.

- **Standard Envelope Support**

The Multi-Purpose Tray, Upper Cassette and Lower Cassettes\* all come standard with envelope support. The design tray design and the use of the envelope attachment makes for simple user installation. These features help to provide more efficient envelope utilization.



\*Envelope Feeder Attachment A (standard) is required.

## PRODUCT DESIGN HIGHLIGHTS

- Staple-free Stapling and Staple On Demand with All Optional Finishers**

These helpful features are available with the optional Inner Finisher-L1, Staple Finisher-AB1, and Booklet Finisher-AB1. Staple-free Stapling binds the paper together with pressure and not the use of metal staples. This helps decrease consumables usage and makes it easier for users to separate their originals. In addition, Staple-free Stapling makes for better, more compact document stacking. While up to 10 sheets can be bound with 17 lb. Bond paper, the more common 20 lb. Bond paper can bind up to 8 sheets using this method – selected either from the print driver or the copy screen finishing options menu.



*Sample Output*

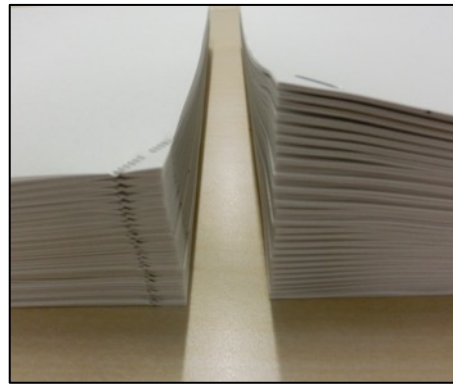

*Stacking Comparison*

Staple On Demand provides a convenience stapler as part of the finisher. This is helpful for re-stapling sets of originals that were unbound in order to feed through the ADF. It is also handy for when the user forgets to choose the staple option from the print driver or copy screen. Staple On Demand supports stapling up to 40 sheets with the Inner Finisher and up to 50 sheets with either External Finisher.



*Staple On Demand with Inner Finisher*



*Staple On Demand with External Finisher*

## PRODUCT DESIGN HIGHLIGHTS

### Easy Maintenance Design

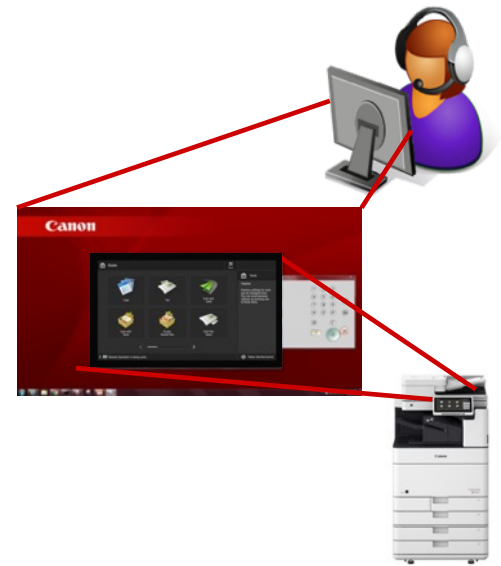
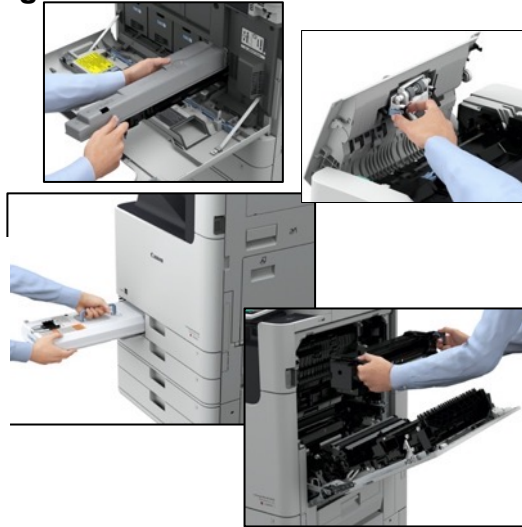

### Installation Aspects

- Compact and lightweight (for the class)
- Fast main unit installation: About 10 minutes or less
- No tools required for installation
- Easy on-screen setup wizard
- Pre-configured with
  - ADF
  - UFR II / PCL 6 / PS 3

### Servicing Aspects

- Easy maintenance
- Longer life parts
- User-replaceable parts\*
  - Fusing Unit
  - ADF Rollers
  - Drum
  - ITB\*\*
- Device UI Animations and Videos

### Diagnostic Aspects

- Standard Remote Operations Software Kit
- See device operation
- Troubleshoot issues proactively

### Installation Benefits

- Fast customer delivery
  - Especially for fleets
- Less time for dealer setup
  - PDLs installed
  - ADF installed
  - Near tool-less
- Potential installation by trained delivery person
- Potential for trained customer setup

### Servicing Benefits

- Fast servicing times
- Designed to provide more customer uptime!
- On-screen videos guide customers
- Trained customers can replace key items
- Good for remote locations, large fleets
- Potential for faster resolution

### Diagnostic Benefits

- See actual customer UI
- Helps diagnose issues remotely
- Helps speed up resolution
- Beneficial to customer help desks
- Training aid
- Resolve some issues without on-site visit
- Helps return device to service fast

\* Customer replacement of key parts is at dealer's discretion.

\*\* Requires additional guidance

## imageRUNNER ADVANCE VALUE PILLARS

### Workflow Efficiency

Designed to help save time and resources and increase productivity with efficient workflows and intuitive ease-of-use



### Cost Management

Identify and address areas for better management of print- and document-related costs



### Security

A range of standard and optional security capabilities to help protect sensitive information



### Device & Fleet Management

Advanced capabilities for efficient fleet management to help ease IT burden and maximize productivity



### Quality & Reliability

Outstanding quality and reliable performance to keep environments moving



### Sustainability

Incorporating responsible design and efficient operation to help achieve environmental goals



For more information on the imageRUNNER ADVANCE value pillars and platform, see the “Third Generation imageRUNNER ADVANCE and imageRUNNER ADVANCE DX Platform Handbook”.

# Configurations and Accessories

## Optional Finishing Accessories



### Staple Finisher-AB1

- 2-tray, 3,250-sheet capacity
- Corner and double stapling up to 50 sheets
- Supports Staple-free Stapling and Staple On Demand
- Supports optional internal 2/3-hole puncher (2/3 Hole Puncher Unit-A1)
- Requires Buffer Pass Unit- P1



### Booklet Finisher-AB1

- 2-tray, 3,250-sheet capacity
- Corner and double stapling up to 50 sheets
- Booklet-making up to 20 sheets and saddle-folding up to 3 sheets
- Supports Staple-free Stapling and Staple On Demand
- Supports optional internal 2/3-hole puncher (2/3 Hole Puncher Unit-A1)
- Requires Buffer Pass Unit- P1



### Inner Finisher-L1\*

- 2-tray, 545-sheet capacity
- Corner and double stapling up to 50 sheets within the footprint of the main unit
- Supports Staple-free Stapling and Staple On Demand
- Supports optional internal 2/3-hole puncher (Inner 2/3 Hole Puncher-D1)



### Buffer Pass Unit-P1

- Required for Staple Finisher-AB1 and Booklet Finisher-AB1

### Inner 2way Tray-M1



### 1<sup>ST</sup> Copy Tray Kit-A1\*\*



### 3<sup>rd</sup> Copy Tray Kit-A1



imageRUNNER  
ADVANCE DX

## Optional Paper Handling Accessories



### Cassette Feeding Unit-AQ1

- Two 550-sheet cassettes
- Supports up to 12" x 18"
- Supports 14 lb. Bond to 140 lb. Index



### High Capacity Cassette Feeding Unit-C1

- 2,450-sheet capacity
- Supports LTR
- Supports 14 lb. Bond to 140 lb. Index



### Paper Deck Unit-F1

- 2,700-sheet capacity
- Supports LTR
- Supports 14 lb. Bond to 140 lb. Index



### Cabinet Type-V

\* Inner Finisher-L1 not available on imageRUNNER ADVANCE DX C5870i.

\*\* Required when Inner Finisher-L1, Staple Finisher-AB1 or Booklet Finisher-AB1 is not installed

Canon

## POWER REQUIREMENTS AND DIMENSIONS



**imageRUNNER ADVANCE DX**

**C5870i/ C5860i/ C5850i**

110-127V, 12A

NEMA 5-15P

**imageRUNNER ADVANCE DX**

**C5840i**

110-127V, 10A

NEMA 5-15P

From  
Main Unit

From  
Main Unit



**Note:**

Total configuration width includes 5 mm space between each component.

# iR ADV DX C5800 vs. iR ADV DX C5700 vs. iR ADV C5500 - HARDWARE

**imageRUNNER**  
ADVANCE DX

The following chart shows some of the key hardware improvements of the imageRUNNER ADVANCE DX C5800 Series as compared to the predecessors imageRUNNER ADVANCE DX C5700 and imageRUNNER ADVANCE C5500 III, C5500 II, C5500 Series.

	imageRUNNER ADVANCE DX	imageRUNNER ADVANCE DX	imageRUNNER ADVANCE
	C5800 Series	C5700 Series	C5500 III/C5500 II/C5500 Series
Models	C5870,C5860,C5850,C5840	C5760,C5750,C5740,C5735	C5560,C5550,C5540,C5535
Copy/Print Speed (BW/Color, LTR)	Up to 70/70 ppm Up to 60/60 ppm Up to 50/50 ppm Up to 40/40 ppm	Up to 60/60 ppm Up to 50/50 ppm Up to 40/40 ppm Up to 35/35 ppm	
Control Panel	Standard: 10.1" Flat Panel Color WSVGA – with Soft-Keys		Standard: 10.1" Flat Panel Color WSVGA – with Hard-Keys
Paper Capacity (Max.)	6,350 Sheets		6,350 Sheets
Paper Weight Support	Cassettes: 14 lb. Bond to 140 lb. index (52-256 g/m²) Multi-purpose Tray: 14 lb. Bond to 110 lb. Cover (52-300 g/m²)		
Memory (Standard)	5 GB	4 GB	4 GB
Memory (Max.)	5 GB	4 GB	4 GB
Storage Device (Standard)	Solid State Drive: 256 GB	Hard Disk Drive: 250 GB	
Storage Device (Max.)	1 TB		
FCOT (BW/Color)	As fast as 2.7 sec. / 3.7 sec.	As fast as 2.9 sec. / 4.5 sec. As fast as 2.9 sec. / 4.5 sec.	
Power Consumption (Sleep Mode)	0.8 W or less		
ADF Scan Speed (1-sided)	BW: 135 ipm (300 dpi) 80 ipm (600 dpi) Color: 135 ipm (300 dpi) 80 ipm (600 dpi)	BW: 80 ipm (300 dpi) 80 ipm (600 dpi) Color: 80 ipm (300 dpi) 60 ipm (600 dpi)	
ADF Scan Speed (2-sided)	BW: 270 ipm (300 dpi) 160 ipm (600 dpi) Color: 270 ipm (300 dpi) 90 ipm (600 dpi)	BW: 160 ipm (300 dpi) 150 ipm (600 dpi) Color: 160 ipm (300 dpi) 80 ipm (600 dpi)	
Toner Yield (BW/Color)	71,000/60,000 images (L Toner 26,000 images)	69,000/60,000 images (L Toner 26,000 images)	
EPEAT Rated	Yes (Rated EPEAT Gold*)		

\* For current EPEAT rating (Gold/Silver/Bronze), please visit [www.epeat.net](http://www.epeat.net).

**Canon**

# iR ADV DX C5800 vs. iR ADV DX C5700 vs.

## iR ADV C5500 - FEATURES

The following chart shows some of the key system improvements of the imageRUNNER ADVANCE DX C5800 Series as compared to the predecessors imageRUNNER ADVANCE DX C5700 and imageRUNNER ADVANCE C5500 III, C5500 II, C5500 Series:

		imageRUNNER ADVANCE DX	imageRUNNER ADVANCE DX	imageRUNNER ADVANCE		
		C5800 Series	C5700 Series	C5500 III Series	C5500 II Series	C5500 Series
Store	Mail Box	Standard (Up to 30,000 pages)				
	Advanced Box	Standard (Available Space: 16 GB w/ Standard SDD; 480 GB w/ Optional SDD)	Standard (Available Space: 16 GB w/ Standard HDD; 480 GB w/ Optional HDD)			
	Search Functionality in Advanced Box	Standard				
	Timeline Support for Access Stored Files (Mail Box/Advanced Box/Network)	Standard			Not Supported	
Print	PCL	Standard				
	PS	Standard				
	Direct Print from Memory Media	Standard (PDF/XPS, EPS, JPEG, TIFF (B/W))				
	Forced Hold Printing	Standard				
	Hot Folders	Standard				
Send	Searchable PDF	Standard				
	OOXML	Standard (.docx/.pptx)				
	Skip Blank Originals	Standard				
	IP Fax	Optional				
	Change SMTP/POP Port Settings from Remote UI	Standard				
Auth.	uniFLOW Online Express (uFOE)*	Standard			Supported	
	Universal Login Manager (ULM)*	Standard				
	User Authentication	Standard				
Security Features	Security Policy Settings	Standard				
	Encryption Kit	N/A	Standard			
	Secure Watermark	Standard			Optional	
	Encrypted PDF	Standard			Optional	
	Digital Signature PDF	Standard			Optional	
	SMB 3.0 Support	Standard				
	Verify System at Startup	Standard			Not Supported	
	McAfee Embedded Control	Standard			Not Supported	
	TLS v1.3 Support	Standard				
	FTPS	Standard				
Other	TPM 2.0	Standard	Not Supported			
	Wireless LAN	Standard				
	MEAP Web Connection Kit	Free (Web Browser Std.)			Optional	
	Home Screen	Standard			Not Supported	
	Unified Firmware Platform	Standard				
	Timeout Setting for Remote UI	Standard				

**Note:** Update to the latest version of the Unified Firmware Platform for access to all available features.

\*Free of charge. However, download, setup and activation is required. Check for interoperability with other third-party solutions.

Paper Type	Paper Size	1-Sided						2-Sided					
		Deck/Cassette			MP Tray			Desk/Cassette			MP Tray		
		Output Tray 1	Output Tray 2	Output Tray 3	Output Tray 1	Output Tray 2	Output Tray 3	Output Tray 1	Output Tray 2	Output Tray 3	Output Tray 1	Output Tray 2	Output Tray 3
Thin 2 (52~59g/m <sup>2</sup> )	A4/LTR/B5/EXE	70.0	70.0	33.0	60	60.0	33.0	70	46	33	65	42	33
Thin1 (60~63g/m <sup>2</sup> )	A5R/STMTR *1	70~5	70~5	33~5	60~5	60~5	33~5	70~5	46~5	33~5	65~5	42~5	33~5
Plain1 (64~75g/m <sup>2</sup> )	A5	70	70	-	60	60	-	-	-	-	-	-	-
Plain2 (76~90g/m <sup>2</sup> )	STMT	-	-	-	60	60	-	-	-	-	-	-	-
Plain3 [230V] (91~105g/m <sup>2</sup> )	A6R	70~5	70~5	-	60~5	60~5	-	-	-	-	-	-	-
Color (64~81g/m <sup>2</sup> )	A4R	42	42	23	41	41	23	42	32	23	41	32	23
Recycled 1 (64~75g/m <sup>2</sup> )	B5R *1	42~5	42~5	26~5	42~5	42~5	26~5	42~5	32~5	26~5	42~5	32~5	26~5
Recycled 2 (76~90g/m <sup>2</sup> )	LTRR	42	42	24	42	42	24	42	32	24	42	32	24
Recycled 3 [230V] (91~105g/m <sup>2</sup> )	B4	40	40	19	35	35	19	40	31	19	37	28	19
Pre-Punched (64~81g/m <sup>2</sup> )	LGL	40	40	20	36	36	20	40	31	20	37	28	20
	A3	36	36	17	31	31	17	36	20	15	33	19	15
	LDR	35	35	17	31	31	17	35	20	15	32	19	15
	12 × 18	20	20	15	20	20	15	20	16	14	20	16	14
	SRA3	-	-	-	19	19	-	-	-	-	19	16	-
Plain3 [100V/120V] (91~105g/m <sup>2</sup> )	A4/LTR/B5/EXE	60	60	28	52	52	28	60	40	28	55	36	28
Recycled3 [100V/120V] (91~105g/m <sup>2</sup> )	A5R/STMTR	60~5	60~5	28~5	52~5	52~5	28~5	60~5	40~5	28~5	55~5	36~5	28~5
Bond (82~99g/m <sup>2</sup> )	A5	60	60	-	52	52	-	-	-	-	-	-	-
Heavy1 (106~128g/m <sup>2</sup> )	STMT	-	-	-	52	52	-	-	-	-	-	-	-
	A6R	60~5	60~5	-	52~5	52~5	-	-	-	-	-	-	-
	A4R	34	34	19	34	34	19	34	26	19	34	26	19
	B5R	34~5	34~5	22~5	34~5	34~5	22~5	34~5	26~5	22~5	34~5	26~5	22~5
	LTRR	34	34	20	34	34	20	34	26	20	34	26	20
	B4	33	33	16	30	30	16	33	25	16	31	24	16
	LGL	33	33	17	30	30	17	33	25	17	31	24	17
	A3	30	30	15	27	27	15	30	17	13	28	16	13
	LDR	30	30	15	27	27	15	30	17	13	28	16	13
	12 × 18	20	20	13	20	20	13	20	14	12	20	14	12
	SRA3	-	-	-	17	17	-	-	-	-	17	13	-
Heavy2 (129~150g/m <sup>2</sup> )	A4/LTR/B5/EXE	30	30	14	25	25	14	30	20	14	27	18	14
Heavy3 (151~163g/m <sup>2</sup> )	A5R/STMTR	30~4	30~4	14~4	25~4	25~4	14~4	30~4	20~4	14~4	27~4	18~4	14~4
Heavy4 (164~180g/m <sup>2</sup> )	A5	30	30	-	25	25	-	-	-	-	-	-	-
Heavy5 (181~220g/m <sup>2</sup> )	STMT	-	-	-	25	25	-	-	-	-	-	-	-
Heavy6 (221~256g/m <sup>2</sup> )	A6R	30~4	30~4	-	25~4	25~4	-	-	-	-	-	-	-
Labels (118~185g/m <sup>2</sup> )	A4R	18	18	10	18	18	10	18	13	10	18	13	10
	B5R	18~4	18~4	12~4	18~4	18~4	12~4	18~4	13~4	12~4	18~4	13~4	12~4
	LTRR	18	18	11	18	18	11	18	13	11	18	13	11
	B4	16	16	8	15	15	8	16	12	8	15	12	8
	LGL	16	16	8	15	15	8	16	12	8	15	12	8
	A3	16	16	7	13	13	7	16	8	6	14	8	6
	LDR	16	16	7	13	13	7	16	8	6	14	8	6
	12 × 18	14	14	6	12	12	6	14	8	6	13	7	6
	SRA3	-	-	-	12	12	-	-	-	-	12	7	-

\*1: The higher speed is the rating for 90 g/m<sup>2</sup> paper in an operating environment of 73.4 degrees F (23 degrees C) and 50% humidity. Productivity may decrease when the temperature decreases below 73.4 F (23 C) or when the paper weight is above 90 g/m<sup>2</sup>.

Paper Type	Paper Size	1-Sided						2-Sided					
		Deck/Cassette			MP Tray			Desk/Cassette			MP Tray		
		Output Tray 1	Output Tray 2	Output Tray 3	Output Tray 1	Output Tray 2	Output Tray 3	Output Tray 1	Output Tray 2	Output Tray 3	Output Tray 1	Output Tray 2	Output Tray 3
Heavy7 (257~300g/m <sup>2</sup> )	A4/LTR/B5/EXE	–	–	–	22	22	12	–	–	–	–	–	–
	A5R/STMTR	–	–	–	22~4	22~4	12~4	–	–	–	–	–	–
	A5/STMT	–	–	–	22	22	–	–	–	–	–	–	–
	A6R	–	–	–	22~4	22~4	–	–	–	–	–	–	–
	A4R	–	–	–	15	15	9	–	–	–	–	–	–
	B5R	–	–	–	15~4	15~4	10~4	–	–	–	–	–	–
	LTRR	–	–	–	15	15	9	–	–	–	–	–	–
	B4	–	–	–	13	13	7	–	–	–	–	–	–
	LGL	–	–	–	13	13	7	–	–	–	–	–	–
	A3	–	–	–	12	12	6	–	–	–	–	–	–
	LDR	–	–	–	12	12	6	–	–	–	–	–	–
	12 × 18	–	–	–	11	11	5	–	–	–	–	–	–
	SRA3	–	–	–	11	11	–	–	–	–	–	–	–
Postcard (164~220g/m <sup>2</sup> )	100 × 148mm	21~4	21~4	–	21~4	21~4	–	–	–	–	–	–	–
	200 × 148mm: 2sheets	21~4	21~4	–	21~4	21~4	–	–	–	–	–	–	–
	200 × 296mm: 4sheets	21	21	–	21	21	–	–	–	–	–	–	–
TAB1~2 (91~128g/m <sup>2</sup> )	A4/LTR	48	48	23	41	41	23	–	–	–	–	–	–
TAB3~4 (129~220g/m <sup>2</sup> )	A4/LTR	24	24	11	20	20	11	–	–	–	–	–	–
Transparency (121~220g/m <sup>2</sup> )	A4/LTR	18	18	–	17	17	–	–	–	–	–	–	–
Envelope	Naga 4 Long Edge Feed	–	–	–	25~4	25~4	–	–	–	–	–	–	–
	Naga 40 Long Edge Feed	–	–	–	25~4	25~4	–	–	–	–	–	–	–
	Yougatanaga 3 Long Edge Feed	25	25	–	25	25	–	–	–	–	–	–	–
	Yougatanaga 3 Short Edge Feed	19~4	19~4	–	19~4	19~4	–	–	–	–	–	–	–
	Nagagata 3 Long Edge Feed	25	25	–	25	25	–	–	–	–	–	–	–
	Nagagata 3 Short Edge Feed	16~4	16~4	–	16~4	16~4	–	–	–	–	–	–	–
	Kakugata 2 Short Edge Feed	14	14	–	14	14	–	–	–	–	–	–	–
	Monarch Long Edge Feed	25~4	25~4	–	25~4	25~4	–	–	–	–	–	–	–
	Monarch Short Edge Feed	25~4	25~4	–	25~4	25~4	–	–	–	–	–	–	–
	ISO-C5 Long Edge Feed	25	25	–	25	25	–	–	–	–	–	–	–
	ISO-C5 Short Edge Feed	19~4	19~4	–	19~4	19~4	–	–	–	–	–	–	–
	DL Long Edge Feed	25	25	–	25	25	–	–	–	–	–	–	–
	DL Short Edge Feed	19~4	19~4	–	19~4	19~4	–	–	–	–	–	–	–
	No.10 (COM10) Long Edge Feed	25	25	–	25	25	–	–	–	–	–	–	–
	No.10 (COM10) Short Edge Feed	19~4	19~4	–	19~4	19~4	–	–	–	–	–	–	–

Paper Type	Paper Size	1-Sided						2-Sided					
		Deck/Cassette			MP Tray			Desk/Cassette			MP Tray		
		Output Tray 1	Output Tray 2	Output Tray 3	Output Tray 1	Output Tray 2	Output Tray 3	Output Tray 1	Output Tray 2	Output Tray 3	Output Tray 1	Output Tray 2	Output Tray 3
Thin 2 (52~59g/m <sup>2</sup> )	A4/LTR/B5/EXE	60	60	28	52	52	28	60	40	28	55	36	28
Thin1 (60~63g/m <sup>2</sup> )	A5R/STMTR *1	60~5	60~5	28~5	52~5	52~5	28~5	60~5	40~5	28~5	55~5	36~5	28~5
Plain1 (64~75g/m <sup>2</sup> )	A5	60	60	—	52	52	—	—	—	—	—	—	—
Plain2 (76~90g/m <sup>2</sup> )	STMT	—	—	—	52	52	—	—	—	—	—	—	—
Plain3 [230V] (91~105g/m <sup>2</sup> )	A6R	60~5	60~5	—	52~5	52~5	—	—	—	—	—	—	—
Color (64~81g/m <sup>2</sup> )	A4R	36	36	19	35	35	19	36	27	19	35	27	19
Recycled 1 (64~75g/m <sup>2</sup> )	B5R *1	36~5	36~5	22~5	36~5	36~5	22~5	36~5	27~5	22~5	36~5	27~5	22~5
Recycled 2 (76~90g/m <sup>2</sup> )	LTRR	36	36	20	36	36	20	36	27	20	36	27	20
Recycled 3 [230V] (91~105g/m <sup>2</sup> )	B4	35	35	16	30	30	16	35	27	16	32	24	16
Pre-Punched (64~81g/m <sup>2</sup> )	LGL	34	34	17	30	30	17	34	26	17	32	24	17
	A3	32	32	15	27	27	15	32	17	13	29	16	13
	LDR	32	32	15	27	27	15	32	17	13	29	16	13
	12 × 18	20	20	13	20	20	13	20	14	12	20	14	12
	SRA3	—	—	—	17	17	—	—	—	—	17	13	—
Plain3 [100V/120V] (91~105g/m <sup>2</sup> )	A4/LTR/B5/EXE	60	60	28	52	52	28	60	40	28	55	36	28
Recycled3 [100V/120V] (91~105g/m <sup>2</sup> )	A5R/STMTR	60~5	60~5	28~5	52~5	52~5	28~5	60~5	40~5	28~5	55~5	36~5	28~5
Bond (82~99g/m <sup>2</sup> )	A5	60	60	—	52	52	—	—	—	—	—	—	—
Heavy1 (106~128g/m <sup>2</sup> )	STMT	—	—	—	52	52	—	—	—	—	—	—	—
	A6R	60~5	60~5	—	52~5	52~5	—	—	—	—	—	—	—
	A4R	34	34	19	34	34	19	34	26	19	34	26	19
	B5R	34~5	34~5	22~5	34~5	34~5	22~5	34~5	26~5	22~5	34~5	26~5	22~5
	LTRR	34	34	20	34	34	20	34	26	20	34	26	20
	B4	33	33	16	30	30	16	33	25	16	31	24	16
	LGL	33	33	17	30	30	17	33	25	17	31	24	17
	A3	30	30	15	27	27	15	30	17	13	28	16	13
	LDR	30	30	15	27	27	15	30	17	13	28	16	13
	12 × 18	20	20	13	20	20	13	20	14	12	20	14	12
	SRA3	—	—	—	17	17	—	—	—	—	17	13	—
Heavy2 (129~150g/m <sup>2</sup> )	A4/LTR/B5/EXE	30	30	14	25	25	14	30	20	14	27	18	14
Heavy3 (151~163g/m <sup>2</sup> )	A5R/STMTR	30~4	30~4	14~4	25~4	25~4	14~4	30~4	20~4	14~4	27~4	18~4	14~4
Heavy4 (164~180g/m <sup>2</sup> )	A5	30	30	—	25	25	—	—	—	—	—	—	—
Heavy5 (181~220g/m <sup>2</sup> )	STMT	—	—	—	25	25	—	—	—	—	—	—	—
Heavy6 (221~256g/m <sup>2</sup> )	A6R	30~4	30~4	—	25~4	25~4	—	—	—	—	—	—	—
Labels (118~185g/m <sup>2</sup> )	A4R	18	18	10	18	18	10	18	13	10	18	13	10
	B5R	18~4	18~4	12~4	18~4	18~4	12~4	18~4	13~4	12~4	18~4	13~4	12~4
	LTRR	18	18	11	18	18	11	18	13	11	18	13	11
	B4	16	16	8	15	15	8	16	12	8	15	12	8
	LGL	16	16	8	15	15	8	16	12	8	15	12	8
	A3	16	16	7	13	13	7	16	8	6	14	8	6
	LDR	16	16	7	13	13	7	16	8	6	14	8	6
	12 × 18	14	14	6	12	12	6	14	8	6	13	7	6
	SRA3	—	—	—	12	12	—	—	—	—	12	7	—

\*1: The higher speed is the rating for 90 g/m<sup>2</sup> paper in an operating environment of 73.4 degrees F (23 degrees C) and 50% humidity. Productivity may decrease when the temperature decreases below 73.4 F (23 C) or when the paper weight is above 90 g/m<sup>2</sup>.

Paper Type	Paper Size	1-Sided						2-Sided					
		Deck/Cassette			MP Tray			Desk/Cassette			MP Tray		
		Output Tray 1	Output Tray 2	Output Tray 3	Output Tray 1	Output Tray 2	Output Tray 3	Output Tray 1	Output Tray 2	Output Tray 3	Output Tray 1	Output Tray 2	Output Tray 3
Heavy7 (257~300g/m <sup>2</sup> )	A4/LTR/B5/EXE	–	–	–	22	22	12	–	–	–	–	–	–
	A5R/STMT	–	–	–	22~4	22~4	12~4	–	–	–	–	–	–
	A5/STMT	–	–	–	22	22	–	–	–	–	–	–	–
	A6R	–	–	–	22~4	22~4	–	–	–	–	–	–	–
	A4R	–	–	–	15	15	9	–	–	–	–	–	–
	B5R	–	–	–	15~4	15~4	10~4	–	–	–	–	–	–
	LTRR	–	–	–	15	15	9	–	–	–	–	–	–
	B4	–	–	–	13	13	7	–	–	–	–	–	–
	LGL	–	–	–	13	13	7	–	–	–	–	–	–
	A3	–	–	–	12	12	6	–	–	–	–	–	–
	LDR	–	–	–	12	12	6	–	–	–	–	–	–
	12 × 18	–	–	–	11	11	5	–	–	–	–	–	–
	SRA3	–	–	–	11	11	–	–	–	–	–	–	–
Postcard (164~220g/m <sup>2</sup> )	100 × 148mm	21~4	21~4	–	21~4	21~4	–	–	–	–	–	–	–
	200 × 148mm: 2sheets	21~4	21~4	–	21~4	21~4	–	–	–	–	–	–	–
	200 × 296mm: 4sheets	21	21	–	21	21	–	–	–	–	–	–	–
TAB1~2 (91~128g/m <sup>2</sup> )	A4/LTR	48	48	23	41	41	23	–	–	–	–	–	–
TAB3~4 (129~220g/m <sup>2</sup> )	A4/LTR	24	24	11	20	20	11	–	–	–	–	–	–
Transparency (121~220g/m <sup>2</sup> )	A4/LTR	18	18	–	17	17	–	–	–	–	–	–	–
Envelope	Naga 4 Long Edge Feed	–	–	–	25~4	25~4	–	–	–	–	–	–	–
	Naga 40 Long Edge Feed	–	–	–	25~4	25~4	–	–	–	–	–	–	–
	Yougatanaga 3 Long Edge Feed	25	25	–	25	25	–	–	–	–	–	–	–
	Yougatanaga 3 Short Edge Feed	19~4	19~4	–	19~4	19~4	–	–	–	–	–	–	–
	Nagagata 3 Long Edge Feed	25	25	–	25	25	–	–	–	–	–	–	–
	Nagagata 3 Short Edge Feed	16~4	16~4	–	16~4	16~4	–	–	–	–	–	–	–
	Kakugata 2 Short Edge Feed	14	14	–	14	14	–	–	–	–	–	–	–
	Monarch Long Edge Feed	25~4	25~4	–	25~4	25~4	–	–	–	–	–	–	–
	Monarch Short Edge Feed	25~4	25~4	–	25~4	25~4	–	–	–	–	–	–	–
	ISO-C5 Long Edge Feed	25	25	–	25	25	–	–	–	–	–	–	–
	ISO-C5 Short Edge Feed	19~4	19~4	–	19~4	19~4	–	–	–	–	–	–	–
	DL Long Edge Feed	25	25	–	25	25	–	–	–	–	–	–	–
	DL Short Edge Feed	19~4	19~4	–	19~4	19~4	–	–	–	–	–	–	–
	No.10 (COM10) Long Edge Feed	25	25	–	25	25	–	–	–	–	–	–	–
	No.10 (COM10) Short Edge Feed	19~4	19~4	–	19~4	19~4	–	–	–	–	–	–	–

Paper Type	Paper Size	1-Sided						2-Sided					
		Deck/Cassette			MP Tray			Desk/Cassette			MP Tray		
		Output Tray 1	Output Tray 2	Output Tray 3	Output Tray 1	Output Tray 2	Output Tray 3	Output Tray 1	Output Tray 2	Output Tray 3	Output Tray 1	Output Tray 2	Output Tray 3
Thin 2 (52~59g/m <sup>2</sup> )	A4/LTR/B5/EXE	50	50	24	43	43	24	50	34	24	47	30	24
Thin1 (60~63g/m <sup>2</sup> )	A5R/STMTR *1	50~4	50~4	24~4	43~4	43~4	24~4	50~4	34~4	24~4	47~4	30~4	24~4
Plain1 (64~75g/m <sup>2</sup> )	A5	50	50	–	43	43	–	–	–	–	–	–	–
Plain2 (76~90g/m <sup>2</sup> )	STMT	–	–	–	43	43	–	–	–	–	–	–	–
Plain3 [230V] (91~105g/m <sup>2</sup> )	A6R	50~4	50~4	–	43~4	43~4	–	–	–	–	–	–	–
Color (64~81g/m <sup>2</sup> )	A4R	30	30	17	30	30	17	30	23	17	30	23	17
Recycled 1 (64~75g/m <sup>2</sup> )	B5R *1	30~4	30~4	19~4	30~4	30~4	19~4	30~4	23~4	19~4	30~4	23~4	19~4
Recycled 2 (76~90g/m <sup>2</sup> )	LTRR	30	30	18	30	30	18	30	23	18	30	23	18
Recycled 3 [230V] (91~105g/m <sup>2</sup> )	B4	30	30	14	25	25	14	30	23	14	27	20	14
Pre-Punched (64~81g/m <sup>2</sup> )	LGL	29	29	14	26	26	14	29	22	14	27	20	14
	A3	27	27	12	22	22	12	27	14	11	24	14	11
	LDR	27	27	12	22	22	12	27	14	11	24	14	11
	12 × 18	20	20	11	20	20	11	20	13	10	20	13	10
	SRA3	–	–	–	17	17	–	–	–	–	17	12	–
Plain3 [100V/120V] (91~105g/m <sup>2</sup> )	A4/LTR/B5/EXE	50	50	24	43	43	24	50	34	24	47	30	24
Recycled3 [100V/120V] (91~105g/m <sup>2</sup> )	A5R/STMTR	50~4	50~4	24~4	43~4	43~4	24~4	50~4	34~4	24~4	47~4	30~4	24~4
Bond (82~99g/m <sup>2</sup> )	A5	50	50	–	43	43	–	–	–	–	–	–	–
Heavy1 (106~128g/m <sup>2</sup> )	STMT	–	–	–	43	43	–	–	–	–	–	–	–
	A6R	50~4	50~4	–	43~4	43~4	–	–	–	–	–	–	–
	A4R	28	28	17	28	28	17	28	22	17	28	22	17
	B5R	28~4	28~4	19~4	28~4	28~4	19~4	28~4	22~4	19~4	28~4	22~4	19~4
	LTRR	28	28	18	28	28	18	28	22	18	28	22	18
	B4	28	28	14	25	25	14	28	22	14	26	20	14
	LGL	28	28	14	26	26	14	28	22	14	27	20	14
	A3	27	27	12	22	22	12	27	14	11	24	14	11
	LDR	27	27	12	22	22	12	27	14	11	24	14	11
	12 × 18	20	20	11	20	20	11	20	13	10	20	13	10
	SRA3	–	–	–	17	17	–	–	–	–	17	12	–
Heavy2 (129~150g/m <sup>2</sup> )	A4/LTR/B5/EXE	30	30	14	25	25	14	30	20	14	27	18	14
Heavy3 (151~163g/m <sup>2</sup> )	A5R/STMTR	30~4	30~4	14~4	25~4	25~4	14~4	30~4	20~4	14~4	27~4	18~4	14~4
Heavy4 (164~180g/m <sup>2</sup> )	A5	30	30	–	25	25	–	–	–	–	–	–	–
Heavy5 (181~220g/m <sup>2</sup> )	STMT	–	–	–	25	25	–	–	–	–	–	–	–
Heavy6 (221~256g/m <sup>2</sup> )	A6R	30~4	30~4	–	25~4	25~4	–	–	–	–	–	–	–
Labels (118~185g/m <sup>2</sup> )	A4R	18	18	10	18	18	10	18	13	10	18	13	10
	B5R	18~4	18~4	12~4	18~4	18~4	12~4	18~4	13~4	12~4	18~4	13~4	12~4
	LTRR	18	18	11	18	18	11	18	13	11	18	13	11
	B4	16	16	8	15	15	8	16	12	8	15	12	8
	LGL	16	16	8	15	15	8	16	12	8	15	12	8
	A3	16	16	7	13	13	7	16	8	6	14	8	6
	LDR	16	16	7	13	13	7	16	8	6	14	8	6
	12 × 18	14	14	6	12	12	6	14	8	6	13	7	6
	SRA3	–	–	–	12	12	–	–	–	–	12	7	–

\*1: The higher speed is the rating for 90 g/m<sup>2</sup> paper in an operating environment of 73.4 degrees F (23 degrees C) and 50% humidity. Productivity may decrease when the temperature decreases below 73.4 F (23 C) or when the paper weight is above 90 g/m<sup>2</sup>.

Paper Type	Paper Size	1-Sided						2-Sided					
		Deck/Cassette			MP Tray			Desk/Cassette			MP Tray		
		Output Tray 1	Output Tray 2	Output Tray 3	Output Tray 1	Output Tray 2	Output Tray 3	Output Tray 1	Output Tray 2	Output Tray 3	Output Tray 1	Output Tray 2	Output Tray 3
Heavy7 (257~300g/㎡)	A4/LTR/B5/EXE	–	–	–	22	22	12	–	–	–	–	–	–
	A5R/STMT	–	–	–	22~4	22~4	12~4	–	–	–	–	–	–
	A5/STMT	–	–	–	22	22	–	–	–	–	–	–	–
	A6R	–	–	–	22~4	22~4	–	–	–	–	–	–	–
	A4R	–	–	–	15	15	9	–	–	–	–	–	–
	B5R	–	–	–	15~4	15~4	10~4	–	–	–	–	–	–
	LTRR	–	–	–	15	15	9	–	–	–	–	–	–
	B4	–	–	–	13	13	7	–	–	–	–	–	–
	LGL	–	–	–	13	13	7	–	–	–	–	–	–
	A3	–	–	–	12	12	6	–	–	–	–	–	–
	LDR	–	–	–	12	12	6	–	–	–	–	–	–
	12 × 18	–	–	–	11	11	5	–	–	–	–	–	–
	SRA3	–	–	–	11	11	–	–	–	–	–	–	–
Postcard (164~220g/㎡)	100 × 148mm	21~4	21~4	–	21~4	21~4	–	–	–	–	–	–	–
	200 × 148mm: 2 sheets	21~4	21~4	–	21~4	21~4	–	–	–	–	–	–	–
	200 × 296mm: 4 sheets	21	21	–	21	21	–	–	–	–	–	–	–
TAB1~2 (91~128g/㎡)	A4/LTR	41	41	20	35	35	20	–	–	–	–	–	–
TAB3~4 (129~220g/㎡)	A4/LTR	24	24	11	20	20	11	–	–	–	–	–	–
Transparency (121~220g/㎡)	A4/LTR	18	18	–	17	17	–	–	–	–	–	–	–
Envelope	Naga 4 Long Edge Feed	–	–	–	25~4	25~4	–	–	–	–	–	–	–
	Naga 40 Long Edge Feed	–	–	–	25~4	25~4	–	–	–	–	–	–	–
	Yougatanaga 3 Long Edge Feed	25	25	–	25	25	–	–	–	–	–	–	–
	Yougatanaga 3 Short Edge Feed	19~4	19~4	–	19~4	19~4	–	–	–	–	–	–	–
	Nagagata 3 Long Edge Feed	25	25	–	25	25	–	–	–	–	–	–	–
	Nagagata 3 Short Edge Feed	16~4	16~4	–	16~4	16~4	–	–	–	–	–	–	–
	Kakugata 2 Short Edge Feed	14	14	–	14	14	–	–	–	–	–	–	–
	Monarch Long Edge Feed	25~4	25~4	–	25~4	25~4	–	–	–	–	–	–	–
	Monarch Short Edge Feed	25~4	25~4	–	25~4	25~4	–	–	–	–	–	–	–
	ISO-C5 Long Edge Feed	25	25	–	25	25	–	–	–	–	–	–	–
	ISO-C5 Short Edge Feed	19~4	19~4	–	19~4	19~4	–	–	–	–	–	–	–
	DL Long Edge Feed	25	25	–	25	25	–	–	–	–	–	–	–
	DL Short Edge Feed	19~4	19~4	–	19~4	19~4	–	–	–	–	–	–	–
	No.10 (COM10) Long Edge Feed	25	25	–	25	25	–	–	–	–	–	–	–
	No.10 (COM10) Short Edge Feed	19~4	19~4	–	19~4	19~4	–	–	–	–	–	–	–

Paper Type	Paper Size	1-Sided						2-Sided					
		Deck/Cassette			MP Tray			Desk/Cassette			MP Tray		
		Output Tray 1	Output Tray 2	Output Tray 3	Output Tray 1	Output Tray 2	Output Tray 3	Output Tray 1	Output Tray 2	Output Tray 3	Output Tray 1	Output Tray 2	Output Tray 3
Thin 2 (52~59g/m <sup>2</sup> )	A4/LTR/B5/EXE	40	40	19	34	34	19	40	26	19	36	23	19
Thin1 (60~63g/m <sup>2</sup> )	A5R/STMTR *1	40~4	40~4	19~4	34~4	34~4	19~4	40~4	26~4	19~4	36~4	23~4	19~4
Plain1 (64~75g/m <sup>2</sup> )	A5	40	40	—	34	34	—	—	—	—	—	—	—
Plain2 (76~90g/m <sup>2</sup> )	STMT	—	—	—	34	34	—	—	—	—	—	—	—
Plain3 [230V]	STMT	—	—	—	34	34	—	—	—	—	—	—	—
(91~105g/m <sup>2</sup> )	A6R	40~4	40~4	—	34~4	34~4	—	—	—	—	—	—	—
Color (64~81g/m <sup>2</sup> )	A4R	24	24	13	23	23	13	24	18	13	23	18	13
Recycled 1 (64~75g/m <sup>2</sup> )	B5R *1	24~4	24~4	15~4	24~4	24~4	15~4	24~4	18~4	15~4	24~4	18~4	15~4
Recycled 2 (76~90g/m <sup>2</sup> )	LTRR	24	24	14	24	24	14	24	18	14	24	18	14
Recycled 3 [230V]	B4	23	23	11	20	20	11	23	18	11	21	16	11
(91~105g/m <sup>2</sup> )	LGL	23	23	11	20	20	11	23	18	11	22	16	11
Pre-Punched (64~81g/m <sup>2</sup> )	A3	21	21	10	17	17	10	21	11	8	19	10	8
	LDR	21	21	10	17	17	10	21	11	8	19	10	8
	12 × 18	19	19	9	16	16	9	19	10	8	17	10	8
	SRA3	—	—	—	14	14	—	—	—	—	14	9	—
Plain3 [100V/120V]	A4/LTR/B5/EXE	40	40	19	34	34	19	40	26	19	36	23	19
(91~105g/m <sup>2</sup> )	A5R/STMTR	40~4	40~4	19~4	34~4	34~4	19~4	40~4	26~4	19~4	36~4	23~4	19~4
Recycled3 [100V/120V]	A5	40	40	—	34	34	—	—	—	—	—	—	—
(91~105g/m <sup>2</sup> )	STMT	—	—	—	34	34	—	—	—	—	—	—	—
Bond (82~99g/m <sup>2</sup> )	A6R	40~4	40~4	—	34~4	34~4	—	—	—	—	—	—	—
Heavy1 (106~128g/m <sup>2</sup> )	A4R	24	24	13	23	23	13	24	18	13	23	18	13
	B5R	24~4	24~4	15~4	24~4	24~4	15~4	24~4	18~4	15~4	24~4	18~4	15~4
	LTRR	24	24	14	24	24	14	24	18	14	24	18	14
	B4	23	23	11	20	20	11	23	17	11	21	16	11
	LGL	23	23	11	20	20	11	23	17	11	21	16	11
	A3	21	21	10	17	17	10	21	11	8	19	10	8
	LDR	21	21	10	17	17	10	21	11	8	19	10	8
	12 × 18	17	17	9	16	16	9	17	10	8	16	10	8
	SRA3	—	—	—	14	14	—	—	—	—	14	9	—
Heavy2 (129~150g/m <sup>2</sup> )	A4/LTR/B5/EXE	30	30	14	25	25	14	30	20	14	27	18	14
Heavy3 (151~163g/m <sup>2</sup> )	A5R/STMTR	30~4	30~4	14~4	25~4	25~4	14~4	30~4	20~4	14~4	27~4	18~4	14~4
Heavy4 (164~180g/m <sup>2</sup> )	A5	30	30	—	25	25	—	—	—	—	—	—	—
Heavy5 (181~220g/m <sup>2</sup> )	STMT	—	—	—	25	25	—	—	—	—	—	—	—
Heavy6 (221~256g/m <sup>2</sup> )	A6R	30~4	30~4	—	25~4	25~4	—	—	—	—	—	—	—
Labels (118~185g/m <sup>2</sup> )	A4R	18	18	10	18	18	10	18	13	10	18	13	10
	B5R	18~4	18~4	12~4	18~4	18~4	12~4	18~4	13~4	12~4	18~4	13~4	12~4
	LTRR	18	18	11	18	18	11	18	13	11	18	13	11
	B4	16	16	8	15	15	8	16	12	8	15	12	8
	LGL	16	16	8	15	15	8	16	12	8	15	12	8
	A3	16	16	7	13	13	7	16	8	6	14	8	6
	LDR	16	16	7	13	13	7	16	8	6	14	8	6
	12 × 18	14	14	6	12	12	6	14	8	6	13	7	6
	SRA3	—	—	—	12	12	—	—	—	—	12	7	—

\*1: The higher speed is the rating for 90 g/m<sup>2</sup> paper in an operating environment of 73.4 degrees F (23 degrees C) and 50% humidity. Productivity may decrease when the temperature decreases below 73.4 F (23 C) or when the paper weight is above 90 g/m<sup>2</sup>.

Paper Type	Paper Size	1-Sided						2-Sided					
		Deck/Cassette			MP Tray			Desk/Cassette			MP Tray		
		Output Tray 1	Output Tray 2	Output Tray 3	Output Tray 1	Output Tray 2	Output Tray 3	Output Tray 1	Output Tray 2	Output Tray 3	Output Tray 1	Output Tray 2	Output Tray 3
Heavy7 (257~300g/㎡)	A4/LTR/B5/EXE	-	-	-	22	22	12	-	-	-	-	-	-
	A5R/STMT	-	-	-	22~4	22~4	12~4	-	-	-	-	-	-
	A5/STMT	-	-	-	22	22	-	-	-	-	-	-	-
	A6R	-	-	-	22~4	22~4	-	-	-	-	-	-	-
	A4R	-	-	-	15	15	9	-	-	-	-	-	-
	B5R	-	-	-	15~4	15~4	10~4	-	-	-	-	-	-
	LTRR	-	-	-	15	15	9	-	-	-	-	-	-
	B4	-	-	-	13	13	7	-	-	-	-	-	-
	LGL	-	-	-	13	13	7	-	-	-	-	-	-
	A3	-	-	-	12	12	6	-	-	-	-	-	-
	LDR	-	-	-	12	12	6	-	-	-	-	-	-
	12 × 18	-	-	-	11	11	5	-	-	-	-	-	-
	SRA3	-	-	-	11	11	-	-	-	-	-	-	-
Postcard (164~220g/㎡)	100 × 148mm	21~4	21~4	-	21~4	21~4	-	-	-	-	-	-	-
	200 × 148mm: 2sheets	21~4	21~4	-	21~4	21~4	-	-	-	-	-	-	-
	200 × 296mm: 4sheets	21	21	-	21	21	-	-	-	-	-	-	-
TAB1~2 (91~128g/㎡)	A4/LTR	32	32	15	27	27	15	-	-	-	-	-	-
TAB3~4 (129~220g/㎡)	A4/LTR	24	24	11	20	20	11	-	-	-	-	-	-
Transparency (121~220g/㎡)	A4/LTR	18	18	-	17	17	-	-	-	-	-	-	-
Envelope	Naga 4 Long Edge Feed	-	-	-	25~4	25~4	-	-	-	-	-	-	-
	Naga 40 Long Edge Feed	-	-	-	25~4	25~4	-	-	-	-	-	-	-
	Yougatanaga 3 Long Edge Feed	25	25	-	25	25	-	-	-	-	-	-	-
	Yougatanaga 3 Short Edge Feed	19~4	19~4	-	19~4	19~4	-	-	-	-	-	-	-
	Nagagata 3 Long Edge Feed	25	25	-	25	25	-	-	-	-	-	-	-
	Nagagata 3 Short Edge Feed	16~4	16~4	-	16~4	16~4	-	-	-	-	-	-	-
	Kakugata 2 Short Edge Feed	14	14	-	14	14	-	-	-	-	-	-	-
	Monarch Long Edge Feed	25~4	25~4	-	25~4	25~4	-	-	-	-	-	-	-
	Monarch Short Edge Feed	25~4	25~4	-	25~4	25~4	-	-	-	-	-	-	-
	ISO-C5 Long Edge Feed	25	25	-	25	25	-	-	-	-	-	-	-
	ISO-C5 Short Edge Feed	19~4	19~4	-	19~4	19~4	-	-	-	-	-	-	-
	DL Long Edge Feed	25	25	-	25	25	-	-	-	-	-	-	-
	DL Short Edge Feed	19~4	19~4	-	19~4	19~4	-	-	-	-	-	-	-
	No.10 (COM10) Long Edge Feed	25	25	-	25	25	-	-	-	-	-	-	-
	No.10 (COM10) Short Edge Feed	19~4	19~4	-	19~4	19~4	-	-	-	-	-	-	-

## ITEM LIST, COUNTRY OF ORIGIN, AND COMPATIBILITY

**imageRUNNER**  
ADVANCE DX

### imageRUNNER ADVANCE DX C5800 Series – Main Unit

Description	Serial Prefix	Country of Origin
imageRUNNER ADVANCE DX C5870i	2XD	Thailand
imageRUNNER ADVANCE DX C5860i	2XK	Thailand
imageRUNNER ADVANCE DX C5850i	2XW	Thailand
imageRUNNER ADVANCE DX C5840i	2YJ	Thailand



# ITEM LIST, COUNTRY OF ORIGIN, AND COMPATIBILITY

## imageRUNNER ADVANCE DX C5800 Series – Hardware Accessories

Description	Serial Prefix	Country of Origin	iR ADV DX C5700 Compatibility	iR ADV DX 5800 Compatibility	iR ADV DX 6000 Compatibility
High Capacity Cassette Feeding Unit-C1	3KP	Thailand	–	✓	–
Cassette Feeding Unit-AQ1	3KN	Thailand	–	✓	–
Cabinet Type-V	-	USA	–	✓	–
Paper Deck Unit-F1	WER	Japan	✓	✓	✓
Booklet Finisher-AB1	2HB	China	–	✓	–
Staple Finisher-AB1	2ZV	China	–	✓	–
Buffer Pass Unit-P1	2AY	China	–	✓	–
2/3 Hole Puncher Unit-A1		Japan	✓	✓	✓
Inner Finisher-L1	2ZX	Japan	–	✓	–
Inner 2/3 Hole Puncher-D1	2NL	Japan	–	✓	–
Inner 2way Tray-M1		Thailand	–	✓	–
1st Copy Tray Kit-A1		Thailand	–	✓	–
3rd Copy Tray Kit-A1		Thailand	–	✓	–
Utility Tray-B1		China	✓	✓	✓
Tab Feeding Attachment-F1		China	✓	✓	✓
Printer Cover-M2		Thailand	–	✓	–
Platen Cover-Y3		China	✓	✓	–
USB Keyboard (Cherry)		USA	✓	✓	✓
Copy Card Reader-F1		Japan	✓	✓	✓
Copy Card Reader Attachment-B7		Japan	✓	✓	✓
Canon Card Set-A1 (1-30)		Japan	✓	✓	✓
Canon Card Set-A2 (31-100)		Japan	✓	✓	✓
Canon Card Set-A3 (101-200)		Japan	✓	✓	✓
Canon Card Set-A4 (201-300)		Japan	✓	✓	✓
Canon Card Set-A5 (301-500)		Japan	✓	✓	✓
Canon Card Set-A6 (501-1000)		Japan	✓	✓	✓
Braille Label Kit-F1		USA	✓	✓	✓
ADF Access Handle-A1		Japan	✓	✓	✓
Copy Control Interface Kit-A1		Japan	✓	✓	✓
Convenience Stapler-A1 (White)		USA	✓	✓	✓
Universal Keyboard Stand-A1		USA	✓	✓	✓
Card Reader Assembly for Universal Keyboard Stand		USA	✓	✓	✓
Attachment kit for Reader		Thailand	✓	✓	✓

\*Blue text indicates updated or new item compared to predecessor model.

# ITEM LIST, COUNTRY OF ORIGIN, AND COMPATIBILITY

## imageRUNNER ADVANCE DX C5800 Series – System Connectivity Accessories

Description	Serial Prefix	Country of Origin	iR ADV DX C5700 Compatibility	iR ADV DX C5800 Compatibility	iR ADV DX 6000 Compatibility
PCL International Font Set-A1	-	-	✓	✓	✓
Barcode Printing Kit-D1	-	-	✓	✓	✓
MEAP Web Connection Kit V5.7 for DX	-	-	✓ (Web Browser Std)	✓ (Web Browser Std)	✓ (Web Browser Std)
<b>Super G3 FAX Board-AX1</b>	-	Thailand	-	✓	-
<b>Super G3 2nd Line Fax Board-AX1</b>	-	China	-	✓	-
<b>Super G3 3rd/4th Line Fax Board-AX1</b>	-	China	-	✓	-
IP FAX Expansion Kit-B1	-	-	✓	✓	✓
Remote FAX Kit-A1	-	-	✓	✓	✓
<b>Memory Mirroring Kit-A1</b>	-	China	-	✓	-
<b>250GB SSD-A1</b>	-	-	-	✓	-
<b>1TB SSD-A1</b>	-	-	-	✓	-
<b>Numeric Keypad-A2</b>	-	-	✓	✓	✓
IC Card Reader Box for Numeric Keypad-A1	-	-	-	✓	✓
Voice Guidance Kit-G1	-	Japan	-	✓	✓
Voice Operation Kit-D1	-	Japan	-	✓	✓
<b>Connection Kit-A3 for Bluetooth LE</b>	-	Thailand	✓	✓	✓
NFC Kit-E2	-	China	✓	✓	✓

## System Connectivity Accessories - imagePASS

Description	Serial Prefix	Country of Origin	iR ADV DX C5700 Compatibility	iR ADV DX C5800 Compatibility	iR ADV DX 6000 Compatibility
<b>imagePASS-R1</b>	-	USA	-	✓	-
Hot Folders License	-	USA	✓	✓	-
Productivity Package Web Activate	-	USA	✓	✓	-
<b>Fiery Compose</b>	-	USA	✓	✓	-
<b>Fiery Impose</b>	-	USA	✓	✓	-
<b>Fiery Impose and Compose</b>	-	USA	✓	✓	-
<b>Fiery with Adobe PDF Print Engine KIT</b>	-	USA	-	✓	-
X-Rite i1 (for imagePASS-P2)	-	USA	✓	✓	-
i1 Publish (i1 Profiler) Software	-	USA	✓	✓	-
Fiery Color Profiler Suite	-	USA	✓	✓	-
Fiery Color Profiler Suite Annual Maintenance	-	USA	✓	✓	-

\*Blue text indicates updated or new item compared to predecessor model.

# ITEM LIST, COUNTRY OF ORIGIN, AND COMPATIBILITY

**imageRUNNER**  
ADVANCE DX

## imageRUNNER ADVANCE DX C5800 Series – Supplies and Consumables

Description	Serial Prefix	Country of Origin	iR ADV DX 5700 Compatibility	iR ADV DX C5800 Compatibility	iR ADV DX 6000 Compatibility
Staple-P1	-	Japan	✓	✓	✓
Staple Cartridge-Y1 <small>(for Booklet Finisher-Y1)</small>	-	Japan	✓	✓	✓
<b>GPR-61 Drum Unit</b>		Japan	-	✓	-
<b>GPR-61 Toner Black</b>	-	Japan	-	✓	-
<b>GPR-61 Toner Cyan</b>	-	Japan	-	✓	-
<b>GPR-61 Toner Magenta</b>	-	Japan	-	✓	-
<b>GPR-61 Toner Yellow</b>	-	Japan	-	✓	-
<b>GPR-61L Toner Cyan</b>	-	Japan	-	✓	-
<b>GPR-61L Toner Magenta</b>	-	Japan	-	✓	-
<b>GPR-61L Toner Yellow</b>	-	Japan	-	✓	-

\*Blue text indicates updated or new item compared to predecessor model.

As an ENERGY STAR® Partner, Canon U.S.A., Inc. has qualified these models as meeting the ENERGY STAR energy efficiency criteria through an EPA recognized certification body. ENERGY STAR and the ENERGY STAR mark are registered U.S. marks. McAfee logos are registered trademarks of McAfee. AirPrint® and the AirPrint® logos are trademarks of Apple, Inc. Google Cloud Print™ is either a registered trademark or trademark of Google Inc. Mopria® is a registered trademark of Mopria® Alliance, Inc. Canon and imageRUNNER logo are registered trademarks of Canon Inc. in the United States and may also be registered trademarks or trademarks in other countries. Microsoft and Windows are either registered trademarks or trademarks of Microsoft Corporation in the United States and/or other countries. All other referenced product names and marks are trademarks of their respective owners and are hereby acknowledged. Specifications and availability subject to change without notice. Products shown with optional accessories. Additional information on software requirements and compatibility is available at [usa.canon.com](http://usa.canon.com). All printer output images are simulated. Canon U.S.A. does not provide legal counsel or regulatory compliance consultancy, including without limitations, Sarbanes-Oxley, HIPAA, GLBA, Check 21 or the USA Patriot Act. Each customer must have its own qualified counsel determine the advisability of a particular solution as it relates to regulatory and statutory compliance. Canon offers security features that can help your business. Many variables can impact the security of your devices and data. Canon does not warrant that the use of its features will prevent malicious attacks, or prevent misuse of devices or data or other security issues. Nothing herein should be construed as legal counsel or regulatory advice concerning customers' compliance with laws related to privacy and security. Customers must have their own qualified counsel determine the feasibility of a particular solution as it relates to regulatory and statutory compliance. Some security settings may affect device functionality or performance. You may want to test these settings before deploying them in your environment to ensure you understand their effects. Some products are shown with optional accessories. Not responsible for typographical errors.

©2020 Canon U.S.A., Inc. All rights reserved.