

1. REMOVE SUBFLOORING TO THE DEPTH OF THE EXTERIOR WALL STUD AND TO THE FULL WIDTH OF THE ROUGH OPENING

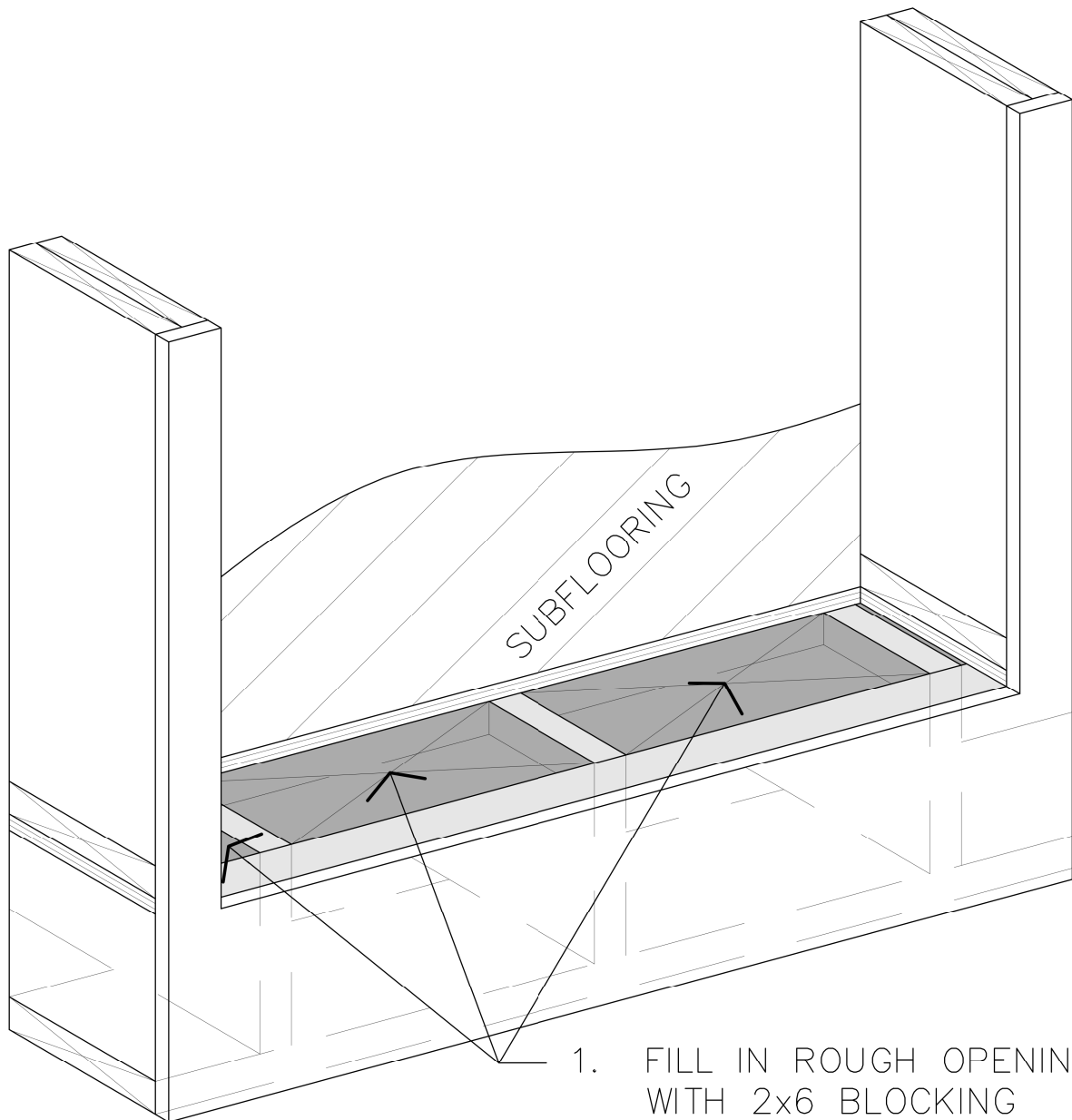

1. FILL IN ROUGH OPENING WITH 2x6 BLOCKING FLUSH WITH THE FLOOR FRAMING
2. INSTALL SILLDRY IN OPENING PER OPTIONAL INSTALLATION (NOTE: SILLDRY WILL OVERLAP TOP OF SUBFLOORING)