

AVAILABLE SIZES
 - 14" x 13" X 2 9/16"

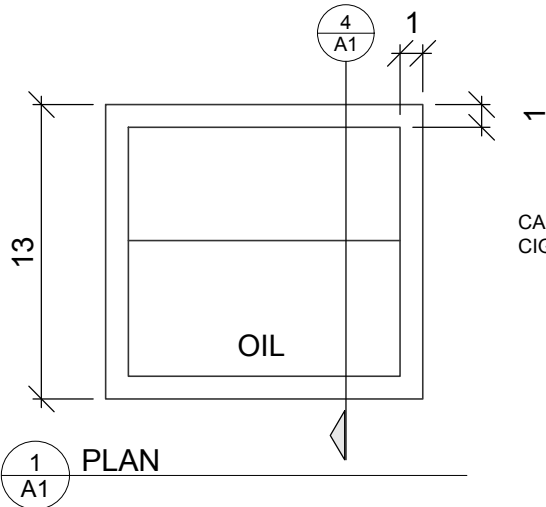

1 PLAN
A1

CAPABLE OF PASSING A CARTON OF CIGARETTES

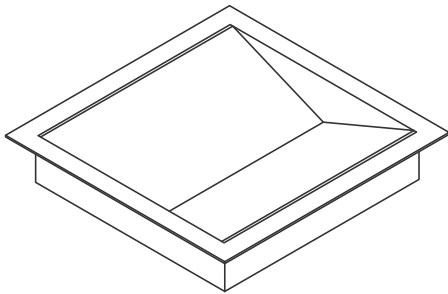

3 ISOMETRIC VIEW
A1

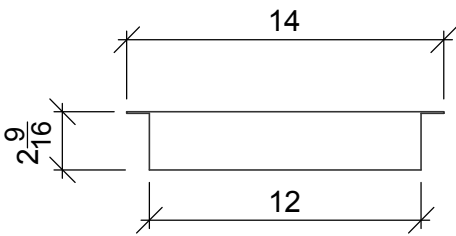

2 ELEVATION
A1

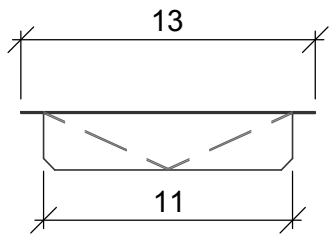

4 SECTION
A1

INSTALL RECESSED CASH TRAY BY ROUTING OUT A HOLE IN THE COUNTERTOP (AS DETAILED)

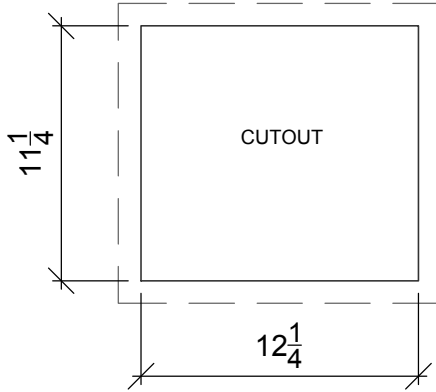

CUT OUT SIZE: 12 1/4" X 11 1/4"

PROJECT NAME: RECESSED OIL TRAY 14" x 13" x 2 9/16"		SHEET TITLE: DETAILS		SHEET NUMBER: A1	
DATE: 01.30.18		DRAWN BY: SRK		REVISIONS:	
ENG. BY:		# DATE DESCRIPTION		JOB#:	
CHECKED BY:				SALES	
<small>The information in this drawing is confidential. It is the property of TOTAL SECURITY SOLUTIONS. Written or verbal reproduction without the written consent of TOTAL SECURITY SOLUTIONS is prohibited.</small>					
Total Security Solutions 935 Garden Lane Foxborough, MA 01939 Phone: 866.847.8079 Fax: 517.223.0805 www.tssolutions.com					
TOTAL SECURITY SOLUTIONS					