

Pilbara Meta Maya Group of Companies

Unit 5, 78-84 Catalano Circuit,
Canning Vale WA 6155
(08) 9455 7441
www.metamaya.com.au



META MAYA CONSTRUCTION PTY LTD

Demonstrated Relevant Experience



RELEVANT EXPERIENCE



Pilbara Meta Maya Regional Aboriginal Corporation (PMMRAC) introduces Meta Maya Construction (MMC)

Over the last 27 years, PMMRAC has had the privilege of working with Indigenous Communities across the Pilbara, Gascoyne and Midwest region of Western Australia. For the last 16 years we have been providing Municipal and Essential services, Property Management, Environmental and Support services to 29 remote Aboriginal communities and have a strong appreciation of the importance of providing reliable and sustainable services in regional and very remote locations.

At the foundation of our Construction Division is a client-focused, dedicated and experienced management group, who provide responsive support to their teams, from planning through to completion. Our core focus is to achieve the best construction solutions for our clients through guaranteed quality of work for Government, private developers and individuals. What sets us apart is our flexibility, rapid response and statewide logistical and trade networks. Our pool of preferred loyal subcontractors, tradesmen and labour are ready for instant deployment, and where possible, the company utilises local suppliers and tradespeople, having over the years built a supplier network that understands our methods and requirements.

We put the safety of our workforce, clients and communities first, and our Quality, Safety and Environmental management system is well planned for specific projects and conducted to minimise any adverse effects on our people, our suppliers and the natural environment.

“Original thinking... Infinite possibilities ”

OUR VISION

Meta Maya Construction (MMC) aims to excel within the construction industry in Western Australia. We strive to deliver a boutique style service to all our clients. Our focus is to always deliver the most up to date design and construction, along with the highest quality, energy efficient, sustainable buildings that create a liveable environment that we are proud to be associated with, that will also leave an environment for current and future generations to enjoy.

PROJECT MANAGEMENT APPROACH

MMC understands that an on time and on budget project outcome is not only down to exceptional planning but also to committed people who have the drive and desire to deliver the very best within their field. We know how to provide outcomes to clients that excel any expectation that is initiated at the first meeting and are also committed to using only qualified, professional project teams and subcontractors.

MEETING CLIENT EXPECTATIONS

MMC understands the fundamental principles of unique project management. We assist them to see the overall picture and what they really want to obtain from the construction of the project. Meeting with our clients from the start advising them in regards to allowances early in the project for potential longer-term needs is not only cost effective, but also good business sense. MMC helps its clients plan today for the future, to save for tomorrow. We provide regular face-to-face feedback to ensure clients are always up to-date on the progress of their projects.





Through our management team and its key personnel, MMC has a wealth of experience globally in all facets of the building industry from small shop fit-outs, to Heritage Restorations, to Multi Storey Apartments and Commercial buildings. We specialise in Tilt Panel, Brick and Concrete, AFS, Modular Buildings and Steel and Timber Frame Construction.

MMC has recently completed a number of high profile fit-outs including sections of Ascot Racecourse including Bars and extensive external decking, two Guylain Chocolate Cafés, one in a Heritage Listed building on St Georges Terrace and the other in Parramatta NSW, Street Eats restaurant at the new Yagan Square, the refurbishment of the Leederville Hotel (Blue Flamingo) including the Car Park and Bottle Shop, new premises for H&R Block, two MiYU shops, one at the new Direct Factory Outlet (DFO) next to Perth Airport and one at the recently redeveloped Westfield Carousel, as well as a number of cafes and base buildings works throughout Perth.

MMC also recently completed the construction of a \$4.6 million shopping centre in Alkimos and the construction of the new DBCA Riverpark Node Project at John Tonkin Park. Additionally, MMC has completed a \$435k Project for the demolition and construction of new sheds for the Department of Biodiversity Conservation and Attractions in Kensington as well as several packages of work to fit-out the new multimillion dollar Shire of Northam Aboriginal Environmental and Interpretive Centre in Northam.

Since inception we have strived to exceed our client's expectations and this is evidenced by the repeat business we receive and the impeccable references our clients provide at the end of each Project.

Quality you deserve and dependability you can count on.

Pilbara Meta Maya Regional Aboriginal Corporation (PMMRAC) through its wholly owned subsidiary, Meta Maya Construction (MMC) will be delivering this project under construction licence number 102166. MMC's registered Builder, Michael Ruggiero (BP 69814) has many years' experience in the commercial and residential building sector holding contracts with the Department of Communities and the Department of Housing to build residential homes in and around the Perth Metro and regional areas, from single dwellings of various sizes to multi leveled apartment complexes. Michael has, in addition, a small niche building business known as Individual Developments but has been working for MMC for the last 2 years, assisting with its growth into other areas of expertise.

MMC operates the sub-contractor model, having the levels of management, Central Services i.e. Finance, Human Resource, Marketing, Quality and Occupational Health and Safety within the core of PMMRAC. MMC has a substantial list of sub-contractors in all areas of construction with some long-standing alliances with Aboriginal organisations. Our experience lies with providing a full design to turnkey handover, offering a unique product to each client. Michael's loyal and trustworthy connection with our tradespeople and suppliers together with his comprehensive understanding of the design and construction process allows us, as a business, to always be one step ahead, and stay competitive within our field.

Example Projects

Osborne Park - Main Street

Project description and main features: Osborne Park is a quality built, architecturally designed apartment complex. The gated complex offers a secure living environment along with undercover parking and private balconies. This apartment complex is the epitome of low maintenance living focused on maximising space and usability.

Total project area:	1012sqm;
Total project cost:	\$3,250,000
Dwellings:	8 Boutique apartments



Yokine - Raymond Street

Project description and main features: This Yokine development comprises of three executive residences all featuring three bedrooms and two bathrooms. They boast living spaces equal to a family sized residence with very spacious family zones on both levels.

Total site area:	1014 sqm
Dwellings:	3
Contract Value:	\$1,350,000



Cloverdale - 189 Gabriel Street

Project description and main features: This project consists of 12 modern and contemporary, well designed 2 story secure walk up apartments. The apartments consist of two bedrooms 1 bathroom and 1 bedroom and 1 bathroom. The façade of the complex has a modern design boasting feature brickwork and a neutral colour scheme, enhancing the functionality of the project as a whole.

Dwellings: 12 Double story walk up apartments
Contract Value: \$ 2,038,327



Agora Shopping Village

The Agora Project in Alkimos consists of 5000sqm of Commercial and Retail space made up of 5 individual tilt panel buildings and includes all Civil Works, Site Works, Storm Water System and Car Parking for 130 Car Parks.

Surrounded by established school and child care facilities, picturesque parks and open spaces, high quality new homes and young families. The centre is located within a busy new community and would suit medical, professional services, retail, specialty stores and more.

Location: Alkimos
Value: \$4,600,000
Duration: 9 months





Uber Offices - Perth

Project description and main features:

The new Uber office fitout in Perth equally integrate the global ridesharing company's white-and-black contrast identity and the local Western Australian landscape and materials to create a mature, yet playful work environment fit for productivity and collaboration. The design is functional and fun with a chic modern look.

Total project area:	5,166sqm
Project cost:	\$ 90,000
Project Location:	Perth
Industry:	Technology, Transportation



KENSINGTON SHEDS PROJECT

Kensington, Perth WA

Project Value: \$435,000

Duration: 12 weeks

The Project: The Department of Biodiversity, Conservation and Attractions was created on 1 July 2017, following the State Government's decision to bring together the Botanic Gardens and Parks Authority, Rottneet Island Authority, Zoological Parks Authority and the former Department of Parks and Wildlife.

The Department is committed to promoting biodiversity and conservation to enrich people's lives, through sustainable management of Western Australia's species, ecosystems, lands and the attractions in the department's care.

Demolition

- Remove Asbestos from shed walls
- Demo Buildings & Make ready for Earthworks
- Air Monitoring performed by Meta Maya Environmental

Earthworks & Car Park Works

- Investigate in ground service locations and identify all services
- Disconnect and remove Distribution Boards
- Remove Kerbs, Bitumen and existing soak well
- Remove 200mm of sub soil
- Install Electrical Conduits to buildings
- Install new soak wells
- Install and grade new limestone sub-base
- Install 5 new Concrete Slabs
- Install new Kerbs and Bitumen
- Re install distribution boards to new location
- Install Line marking

Shed Construction

- Erect sheds x 5
- Fit off electrical to all sheds (Lighting and Power)
- Seal Concrete Slabs x 5
- Commission Sheds x 5

Landscaping

A variety of modern Australian sun-hardy, water efficient plants finish the project, resulting in an environmentally friendly and visually appealing site.





Street Eats - Fitout

A modern and edgy eatery located in the City of Perth. Street Eats style is relaxed and chilled making it easy to relax while they serve you some of the worlds greatest street foods.

Location: Yagan Square

Contract Value: \$ 280,000

Duration: 9 weeks



Ascot Decking and Pavilion Bar

The Ascot Bar is the ideal place to catch up with friends and enjoy the races!

Demolition and Construction of Decking and Pavilion Bar.

Demolition of various structures and Refurbishment of Pavillion Public Bar Area and Stands.

Development Application and Building Permit was required for these works.

Location: Ascot Racecourse
Value: \$223,000.00
Duration: 9 weeks

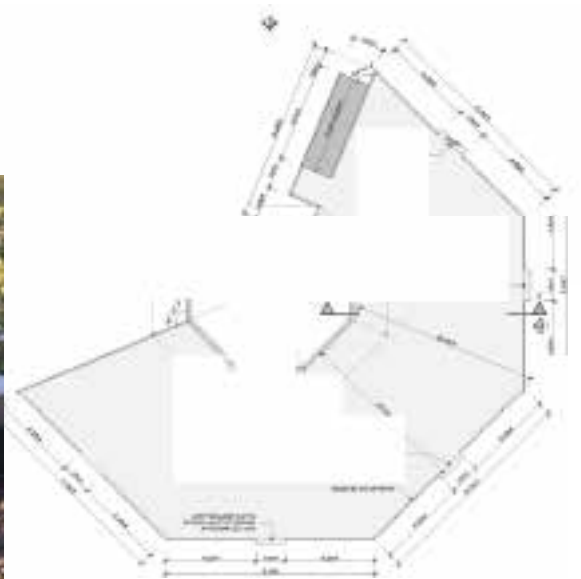





Restoration Project at the John Point lookout, gun emplacement and observation post.

Cape Peron

Location: Rockingham

Value: \$188,000

Duration: 12 weeks

Overlooking the Indian Ocean in Rockingham, the Cape Peron Coastal Defense Battery or "K" Battery begun late in 1942 but never fired an angry shot. The war zone soon moved away from Western Australia and the battery was decommissioned early in 1945.

The Cape Peron Battery consisted of two 155mm Guns, a large observation post and operations centre with bunkers for housing personnel, storage of ammunition etc. All were connected by subterranean tunnels.



Before Restoration





The Blue Flamingo

Location: 742 Newcastle St,
Leederville WA 6007
Value: \$188,000
Duration: 12 weeks

Inspired by South America and the Californian coast, this Leederville space has all your party needs sorted. With fun cocktails to refresh those tastebuds, plus delish eats to match – there's a reason this themed courtyard is one of Perth's fav social spots. Drinks, music and cages come and explore the paradise that is Blue Flamingo and dance like no one is watching.

Some information taken from - www.theblueflamingo.com.au







Derby - Staff Housing

MMC have undertaken a project for the State Government to build 3 residential homes in Derby. This project is coming to end of defect period and should be signed off shortly.

Dwellings: 3 (2 x double level and
1 x single level)
Contract Value: \$2,600,000





Fenians Bar

Location: Perth

Value: \$20,000

Duration: 1 Weeks

Restoration works, signage and painting. Ideally located on the corner of Adelaide Terrace and Hill Street, Perth's original Irish Pub is the place to meet for a quick drink or a great pub meal. It's also the perfect venue for your next function.





A modern, office fit-out complete with quiet spaces, tasteful, well equipped amenities and acoustic designed roof to reduce noise. Designed for the individual needs of the organisation's atmosphere and to assist in staff's ability to work effectively and efficiently.

Kensington Office fit-out

Location: Kensington

Value: \$400,000

Duration: 6 months



MiYU Store Fit-outs

Location: DFO
Value: \$80,000
Duration: 4 weeks

Perth's number one Japanese variety store. Two separate internal fit-outs, one at Westfield Carousel Cannington, the other inside the Direct Factory Outlet (DFO) located at the Perth Airport.

Location: Westfield Carousel
Value: \$60,000
Duration: 4 weeks



Guylian Belgian Chocolate Cafe - Perth

An important heritage restoration and fit-out, the Guylian project was a labour of love. Restoring the stunning building to its original splendor and seeing the final results were nothing less than amazing.

Location: 101 St Georges Terrace, Perth WA 6000
Value: \$1,300,000
Duration: 16 weeks

Located in the heart of Perth CBD Guylian Chocolate Cafe boasts plush furniture and decor that oozes a relaxed but formal sophistication.

Indulge your passion for the finest Belgian chocolates, exquisite cakes and decadent desserts. Enjoy a glass of champagne or a coffee as you take a delicious journey of discovery. Experience the rich, luscious flavours that only Guylian promises. Delight in our extravagant petit fours and individual desserts.

Ideal for breakfast, lunch, an after work drink or even a shopping break – just indulge, enjoy, relax. The perfect spot to enjoy something delectable either before or after the theatre with friends.





Guylian Chocolate Cafe Parramatta

Full internal high specification fit-out and heritage restoration in Parramatta, Sydney.

Location: Parramatta
Value: \$550,000
Duration: 9 weeks



Northam Aboriginal Interpretive Centre

The Bilya Koort Boodja Centre for Nyoongar Culture and Environmental Knowledge is located in the Shire of Northam on the foreshore of the Avon River in Northam's CBD. This regional tourist attraction offers an interactive educational experience that recognises the rich Aboriginal and environmental presence in the Nyoongar Ballardong region. The Centre will protect, celebrate and share the culture of the Nyoongar people and highlight land management practices that draws upon the knowledge of the land's traditional custodians.

MMC undertook a number of carpentry work packages.

Location:	Northam
Value:	\$290,000
Duration:	8 Weeks





Information taken from the Bilya Koort Boodja website. <https://www.bilyakoortboodja.com/>

John Tonkin Interpretation Nodes

The interpretation nodes are structures that link into existing foreshore pathways, shaped to create a multi-use space providing seating, interpretation and improved foreshore access. The facilities are designed to meet universal access standards, which increases recreational opportunities for a range of abilities. The aim is to make visitors more aware of the natural, historic, social and Aboriginal heritage of the Riverpark.

The interpretation aspects of the node draw upon visual elements, sound and art to enable the visitor to engage with the information in a variety of ways. Besides static interpretive panels, where applicable the signage will also prompt visitors to download an app and listen to cultural heritage audio stories about the river, by accessing the virtual trail guides.

Location: Fremantle
Value: \$190,000
Duration: 3 months







Meta Maya Construction Pty Ltd

Unit 5, 78-84 Catalano Circuit,
Canning Vale WA 6155

(08) 9455 7441

enquiries@metamaya.com.au

www.metamaya.com.au

- 100% Australian Owned
- 27 Years in business
- Robust integrated ISO Certified QSE Systems
- 90+ Personnel
- National Coverage
- Registered Building Contractor
- Master Builder Member

